

K-VTL BEITSEITIG

Distributor blocks, outlets on both sides (front and back)

HANSA FLEX

Caracteristici

Fixare	2 mounting holes in housing (screw size M 5)
Presiune de lucru	max. 10 bari
Domeniu de temperaturi	-10 °C to +100 °C
Material	Aluminiu

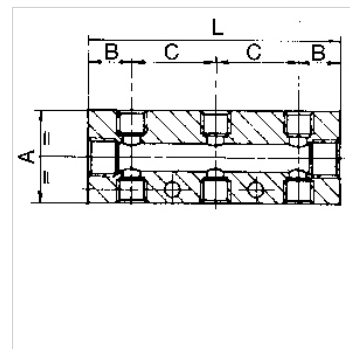
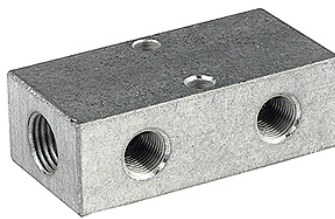

Indicație

Alte date sunt disponibile la cerere.

Descriere

For easy assembly of compressed air taps (screw fittings, unions, couplings, etc.).
Optionally with 2, 3, 4, or 6 outlets on one side or both sides.

Articol

Denumire	Racord de ieșire	Racord de intrare	A (mm)	B (mm)	C (mm)	L (mm)
K- 07 40 40 28	2 + 2 x M 5	2 x 1/8	20,0	15,0	15,0	45,0
K- 07 40 53 02	3 + 3 x M 5	2 x 1/8	20,0	15,0	15,0	60,0
K- 07 40 40 29	4 + 4 x M 5	2 x 1/8	20,0	15,0	15,0	75,0
K- 07 40 53 03	6 + 6 x M 5	2 x 1/8	20,0	15,0	15,0	105,0
K- 07 40 40 22	2 + 2 x 1/8	2 x 1/4	30,0	15,0	30,0	60,0
K- 07 40 52 92	3 + 3 x 1/8	2 x 1/4	30,0	15,0	30,0	90,0
K- 07 40 40 23	4 + 4 x 1/8	2 x 1/4	30,0	15,0	30,0	120,0
K- 07 40 52 93	6 + 6 x 1/8	2 x 1/4	30,0	15,0	30,0	180,0
K- 07 40 40 24	2 + 2 x 1/4	2 x 3/8	40,0	18,0	36,0	72,0
K- 07 40 52 95	3 + 3 x 1/4	2 x 3/8	40,0	18,0	36,0	108,0
K- 07 40 40 25	4 + 4 x 1/4	2 x 3/8	40,0	18,0	36,0	144,0
K- 07 40 52 96	6 + 6 x 1/4	2 x 3/8	40,0	18,0	36,0	216,0
K- 07 40 40 26	2 + 2 x 1/4	2 x 1/2	40,0	22,0	36,0	80,0
K- 07 40 52 99	3 + 3 x 1/4	2 x 1/2	40,0	22,0	36,0	116,0
K- 07 40 40 27	4 + 4 x 1/4	2 x 1/2	40,0	22,0	36,0	152,0
K- 07 40 53 00	6 + 6 x 1/4	2 x 1/2	40,0	22,0	36,0	224,0