

K-FI MIKRO PC-BEHAEL MULTIFIX MINI

Micro-filters with polycarbonate bowl

HANSA FLEX

Caracteristici

| | |
|-----------------------------|--|
| Presiune de intrare | Max. 16 bar |
| Temperatură mediu | max. 60 °C |
| Temperatură ambientală | Max. 60 °C |
| Finețea filtrului | 0,01 μm |
| Randament | 99.999 % |
| Material de etanșare | NBR |
| Cartuș de filtru | Borosilicate-POM |
| Carcasă | Die-cast zinc |
| Drain valve | Semi-automatic |
| Măsurarea valorii debitului | FM at P1 = 6 bar and pressure drop $\Delta p = 0.09$ bar |

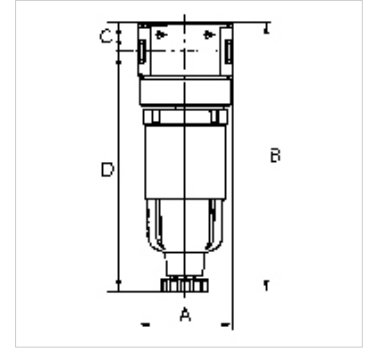

Indicație

If several devices in the »multifix-mini« Series are assembled together, the maximum working pressure is 12 bar.
Alte date sunt disponibile la cerere.

Descriere

Micro-filters for compliance with strict compressed air purity requirements. Suitable for all applications where standard filters do not afford the desired efficiency.

Articol

| Denumire | Filet | Debit (L/min) | A (mm) | B | C (mm) | D (mm) | DN |
|----------------|-------|---------------|--------|----------|--------|--------|----|
| K- 07 25 10 54 | G 1/8 | 230 | 40,0 | 114,8 mm | 12,3 | 102,5 | 5 |
| K- 07 25 10 56 | G 1/4 | 450 | 40,0 | 138,1 mm | 12,3 | 125,8 | 5 |

Piese de schimb

| | |
|------------------------|-----------------------|
| K-AUTOMAT ABLASSVENTIL | Automatic drain valve |
| K-KOPPELPAKET MEHR | Coupling packet |