

# K-FI METALLBEHAEL H ALV MULTIFIX MI

Filters with metal bowl and semi-automatic drain valve

**HANSA FLEX**

## Caracteristici

<b>Presiune de intrare</b>	Max. 16 bar (polycarbonate bowl), Max. 20 bar (metal bowl)
<b>Temperatură mediu</b>	max. 60 °C
<b>Temperatură ambientală</b>	Max. 60 °C
<b>Debit</b>	1000 l/min
<b>Mărimea porilor în elementul filtrant</b>	5 µm
<b>Carcasă</b>	Die-cast zinc
<b>Drain valve</b>	Semi-automatic
<b>Măsurarea valorii debitului</b>	At P2 = 6 bar and pressure drop $\Delta p = 1$ bar

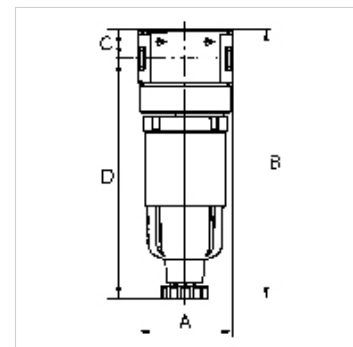

## Indicație

If several devices in the »multifix-mini« Series are assembled together, the maximum working pressure is 12 bar.  
Alte date sunt disponibile la cerere.

## Descriere

Centrifugal separators with a sintered filter element.

## Articol

Denumire	Filet	A (mm)	B	C (mm)	D (mm)	DN	Dimensiunea constructivă
K- 07 25 00 43	G 1/8	40,0	111,6 mm	12,3	99,3	5	0
K- 07 25 00 45	G 1/4	40,0	111,6 mm	12,3	99,3	5	0

## Piese de schimb

K-AUTOMAT ABLASSVENTIL	Automatic drain valve
K-KOPPELPAKET MEHR	Coupling packet
K-ERSATZBEHAELTER MULTI MINI	Spare tank »multifix-mini« & »standard-mini«
K-PC-BEHAELTER FILTER MULTIFIX	Polycarbonate tank filter
K-FILTERELEMENT	Filter element