

# K-3/2-BKR MULTIFIX MINI

Ball valves

**HANSA FLEX**

## Caracteristici

Temperatură mediu	max. 60 °C
Temperatură ambientală	Max. 60 °C
Acționare	Twist knob, rotatable 90°
Debit	1800 l/min
Racord de dezaerare	Silencer G 1/4
Material de etanșare	NBR
Carcasă	Die-cast zinc
Măsurarea valorii debitului	At P1 = 6 bar and pressure drop $\Delta p = 1$ bar

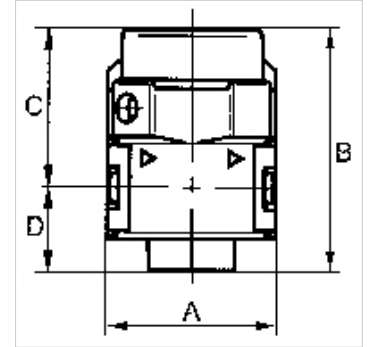
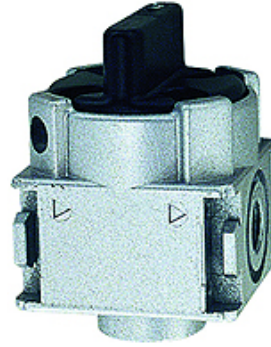

## Indicație

If several devices in the »multifix-mini« Series are assembled together, the maximum working pressure is 12 bar.  
Alte date sunt disponibile la cerere.

## Descriere

Rotary switch can be turned 90°, lockable, with relief port

## Articol

Denumire	Filet	A (mm)	B	C (mm)	D (mm)	Dimensiunea constructivă
K- 07 25 11 56	G 1/8	40,0	57,6 mm	37,6	20,0	0
K- 07 25 11 57	G 1/4	40,0	57,6 mm	37,6	20,0	0

## Piese de schimb

K-KOPPELPAKET MEHR	Coupling packet
K-AUTOMAT ABLASSVENTIL	Automatic drain valve
K-SCHALLDAE SINTERBR SCHLITZ	Silencers, sintered bronze, slotted