

# K-SCHALTVENTILE 3/2 MULTIFIX MINI

On-off valves (3/2-way valves)

**HANSA FLEX**

## Caracteristici

<b>Presiune de intrare</b>	Min. 2 bar, max. 10 bar
<b>Temperatură mediu</b>	max. 60 °C
<b>Temperatură ambientală</b>	Max. 60 °C
<b>Conexiune electrică</b>	Device plug PG 9, type B, EN 175301-803
<b>Tip de protecție</b>	IP 65 (P 54) acc. to DIN 40050
<b>Debit</b>	1600 l/min
<b>Durată de comutare relativ</b>	100 %
<b>Racord de dezaerare</b>	Silencer G 1/4
<b>Material de etanșare</b>	NBR
<b>Carcasă</b>	Die-cast zinc
<b>Măsurarea valorii debitului</b>	At P1 = 6 bar and pressure drop $\Delta p = 1$ bar

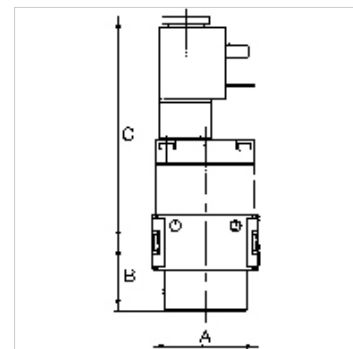

## Indicație

If several devices in the »multiflex-mini« Series are assembled together, the maximum working pressure is 12 bar.  
Alte date sunt disponibile la cerere.

## Descriere

Pneumatic systems or parts of systems can be switched on and off by means of an electrical signal. When they are switched off, the system is relieved at the same time.

## Articol

Denumire	Filet	Bobină magnetică	A (mm)	B	C (mm)	Dimensiunea constructivă
K- 07 25 11 62	G 1/4	230 V AC, 50 Hz	45,0	29,0 mm	96,0	0
K- 07 25 11 63	G 1/4	110 V AC, 50 Hz	45,0	29,0 mm	96,0	0
K- 07 25 11 64	G 1/4	24 V DC	45,0	29,0 mm	96,0	0

## Piese de schimb

K-KOPPELPAKET MEHR	Coupling packet
K-GERAETESTECKER	Coupling socket
K-AUTOMAT ABLASSVENTIL	Automatic drain valve
K-MAGNETSPULE MULTIFIX	Solenoid
K-SCHALLDAE SINTERBR SCHLITZ	Silencers, sintered bronze, slotted