

K-FI METALLBEHAELTER STANDARD-MINI

Filters with metal bowl

HANSA FLEX

Caracteristici

| | |
|--|--|
| Presiune de intrare | Max. 16 bar (polycarbonate bowl), Max. 25 bar (metal bowl) |
| Temperatură mediu | max. 60 °C |
| Temperatură ambientală | Max. 60 °C |
| Debit | 800 l/min |
| Mărimea porilor în elementul filtrant | 8 µm |
| Material de etanşare | NBR |
| Carcasă | Die-cast zinc, painted silver |
| Drain valve | Semi-automatic for variant with polycarbonate bowl, Manual for variant with metal bowl |
| Măsurarea valorii debitului | At P2 = 6 bar and pressure drop $\Delta p = 1$ bar |
| Alte date | User manual on request |

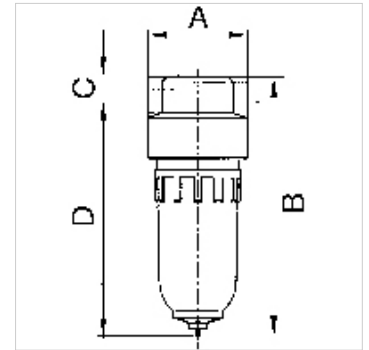

Descriere

Centrifugal separators with a sintered filter element. Compact design.

Articol

| Denumire | Filet | A (mm) | B | C (mm) | D (mm) | DN |
|----------------|-------|-----------|----------|-----------|-----------|----|
| K- 07 25 05 83 | G 1/8 | 40,0 | 108,5 mm | 10,0 | 98,5 | 5 |
| K- 07 25 05 84 | G 1/4 | 40,0 | 108,5 mm | 10,0 | 98,5 | 5 |

Piese de schimb

| | |
|--------------------------------|---|
| K-ERSATZBEHAELTER MULTI MINI | Spare tank »multifix-mini« & »standard-mini« |
| K-PC-BEHAELTER FILTER MULTIFIX | Polycarbonate tank filter |
| K-FILTERELEMENT | Filter element |
| K-AUTOMAT ABLASSVENTIL | Automatic drain valve |
| K-LOESBARE DOPPELNIPPEL MS | Double nipples |
| K-XV AGM MS NI | Double nipples, parallel male thread, nickel-plated brass |