

# K-NIPPEL KUPPL STREAM LINE

Plugs for couplings DN 7.2 - DN 7.8, hardened and galvanised steel  
»stream line«

**HANSA FLEX**

## Caracteristici

Presiune de lucru	Max. 16 bar
Debit aer	2.100 l/min (at 6 bar and $\Delta p = 0.5$ bar)
Temperatură mediu	-20 °C to +100 °C
Material	hardened zinc plated steel

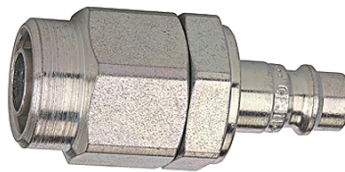

## Indicație

Alte date sunt disponibile la cerere.

## Articol

Denumire	Definiție	SW (mm)
K- 07 35 12 92	Plug for hose 10x6,5	16
K- 07 35 12 93	Plug for hoseh 12x8	19
K- 07 35 12 94	Plug for hose 13,5x9,5	21
K- 07 35 00 61	Plug for hose 16x11	24

## este element adițional la următoarele produse

K-SVKM NW 7,6 AG ST-MS VZ	Quick disconnect couplings DN 7.6, galvanised steel / brass, male
K-SVKM NW 7,6 IG ST	Quick disconnect couplings DN 7.6, galvanised steel / nickel-plated brass, female
K-SVKM NW 7,6 SCHL TUE ST VZ	Quick disconnect couplings DN 7.6, galvanised steel / brass, with hose connector
K-SVKM NW 7,6 STREAM LINE ST	Quick disconnect couplings DN 7.6, galvanised steel / brass, »stream line«