

# K-VERSCHLUSSKAPPEN 10 BAR

Hexagonal caps (pressure max. 10 bar)

**HANSA FLEX**

## Caracteristici

|                        |  |
|------------------------|--|
| Presiune de lucru      | Max. 15 bar, coarșe vacuum   |
| Domeniul de utilizare  | Air, vacuum  |
| furtunuri recomandate  | PU or PA (nylon)   |
| Medii                  | Compressed air and all gases or liquids that are compatible with the materials |
| Domeniu de temperaturi | -20 °C to +80 °C   |
| Suprafață de etanșare  | Parallel version: O-ring in housing, Conical version: thread coating           |
| Material               | Plastic, Nickel plated brass   |
| Inel de presiune       | Plastic  |

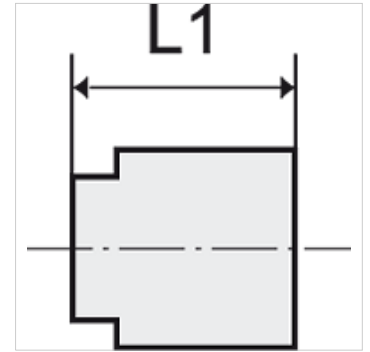
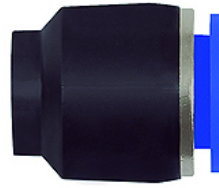

## Indicație

Alte date sunt disponibile la cerere.

## Descriere

Push-in fittings series manufactured in plastic and nickel-plated brass. All parts are suitable for use with hoses, tubes or pipes made of plastic and copper.

## Articol

| Denumire       | pentru $\varnothing$ exterior furtun | L1<br>(mm) |
|----------------|--------------------------------------|------------|
| K- 07 40 42 96 | 3 mm                                 | 16,0       |
| K- 07 40 42 97 | 4 mm                                 | 16,0       |
| K- 07 40 42 98 | 6 mm                                 | 20,0       |
| K- 07 40 42 99 | 8 mm                                 | 21,0       |
| K- 07 40 43 00 | 10 mm                                | 22,0       |
| K- 07 40 43 01 | 12 mm                                | 23,0       |
| K- 07 40 43 02 | 16 mm                                | 25,0       |