

# K-MV G (NC) D 24 V DC STA

Normally closed, (NC), directly operated, 24 V DC, standard type

**HANSA FLEX**

## Caracteristici

<b>Conexiune electrică</b>	device socket type A in acc. with ISO 4400 for all valves with threads G 3/8 & G 1/2, except valves type 3 & 4. Device socket
<b>Descriere filet</b>	G thread acc. DIN EN ISO 228-1
<b>Temperatură mediă</b>	max. 80 °C when using water or oils; max. 90 °C when using with air
<b>Tip de protecție</b>	IP 65
<b>presiune max. de lucru</b>	10 bar
<b>Material de etanșare</b>	FPM
<b>Carcasă, scaun al supapei</b>	Stainless steel 1.4301
<b>Piese interioare</b>	Stainless steel

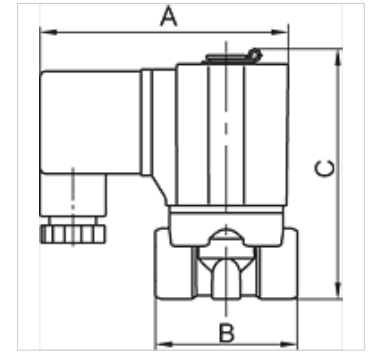

## Indicație

Alte date sunt disponibile la cerere.

## Descriere

Standard series in two different versions: Directly operated, Pilot-operated

## Articol

Denumire	Filet	NW	A (mm)	B (mm)	C (mm)	Forma constructivă
K- 07 30 01 20	G 1/8	3,0	70,0	40,0	70,7	1
K- 07 30 01 21	G 1/4	3,0	70,0	40,0	70,7	1
K- 07 30 01 22	G 3/8	5,0	85,0	52,0	87,0	1
K- 07 30 01 23	G 1/2	5,0	85,0	52,0	87,0	1