

K-L-STECK STECKNIPPEL VB MINI

Union elbows with push-in plug, mini

HANSA FLEX

Caracteristici

Presiune de lucru Max. 10 bar, vacuum

Domeniul de utilizare Air, vacuum

furtunuri recomandate PU or PA (nylon)

Medii Aer comprimat

Domeniu de temperaturi 0 °C to +60 °C

Material Plastic, Nickel plated brass

Inel de presiune Plastic

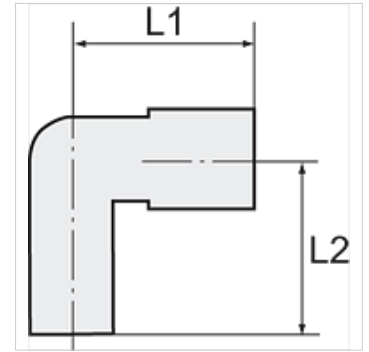

Indicație

Alte date sunt disponibile la cerere.

Descriere

Push-in fittings series manufactured in plastic and nickel-plated brass, space-saving miniature design.

Articol

Denumire	pentru Ø exterior furtun	L1 (mm)	L2 (mm)	Niplu coaxial (mm)
K- 07 40 50 07	3 mm	11,5	26,6	3
K- 07 40 50 08	4 mm	14,0	28,5	4
K- 07 40 50 09	6 mm	16,3	32,0	6