

# K-W90 DREH AG OR FKM

Male elbows, swivel type, parallel male thread with FPM O-ring

**HANSA FLEX**

## Caracteristici

Presiune de lucru Max. 18 bar

Material de etanșare Buna-N

Material Alamă nichelată

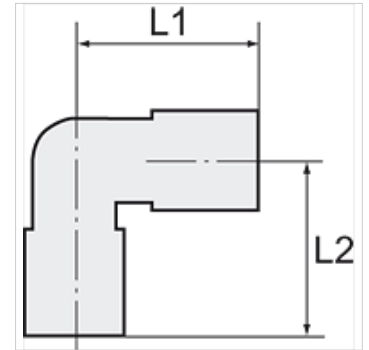

## Indicație

Alte date sunt disponibile la cerere.

## Articol

Denumire	Filet	pentru furtun	L1 (mm)	L2 (mm)	Deschiderea cheii fixe
K- 07 40 31 49	G 1/8	6 mm / 4 mm	20,5	21,0	10 mm
K- 07 40 31 51	G 1/8	8 mm / 6 mm	21,0	21,0	10 mm
K- 07 40 31 45	G 1/4	6 mm / 4 mm	21,5	22,5	10 mm
K- 07 40 31 47	G 1/4	8 mm / 6 mm	22,0	24,0	12 mm
K- 07 40 31 43	G 1/4	10 mm / 8 mm	24,0	24,0	12 mm