

K-MV G (NC) D 230 V, 50 HZ STA 1

Normally closed, (NC), directly operated, 230 V, 50 Hz, standard type

HANSA FLEX

Caracteristici

| | |
|----------------------------------|---|
| Conexiune electrică | device socket type A in acc. with ISO 4400 for all valves with threads G 3/8 & G 1/2, except valves type 3 & 4. Device socket |
| Descriere filet | G thread acc. DIN EN ISO 228-1 |
| Temperatură mediu | max. 80 °C when using water or oils; max. 90 °C when using with air |
| Tip de protecție | IP 65 |
| presiune max. de lucru | 10 bar |
| Material de etanșare | FKM |
| Carcasă, scaun al supapei | Stainless steel 1.4301 |
| Piese interioare | Stainless steel |
| Material | sealing: FKM (FPM) |

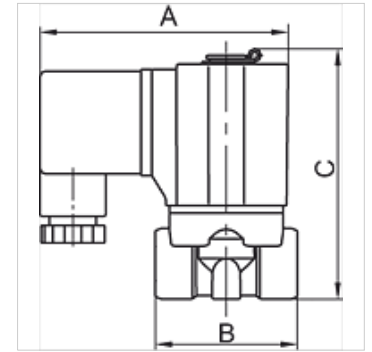

Indicație

Alte date sunt disponibile la cerere.

Descriere

Standard series in two different versions: Directly operated, Pilot-operated

Articol

| Denumire | Filet | NW | A (mm) | B (mm) | C (mm) | Forma constructivă |
|----------------|-------|-----|-----------|-----------|-----------|--------------------|
| K- 07 30 01 12 | G 1/8 | 3,0 | 70,0 | 40,0 | 70,7 | 1 |
| K- 07 30 01 13 | G 1/4 | 3,0 | 70,0 | 40,0 | 70,7 | 1 |
| K- 07 30 01 14 | G 3/8 | 5,0 | 85,0 | 52,0 | 87,0 | 1 |
| K- 07 30 01 15 | G 1/2 | 5,0 | 85,0 | 52,0 | 87,0 | 1 |