

# K-ABSPV STECK

Shut-off valves with plug connection

## Caracteristici

<b>Presiune de lucru</b>	Max. 15 bar, coarse vacuum
<b>Domeniul de utilizare</b>	Air, vacuum
<b>furtunuri recomandate</b>	PU or PA (nylon)
<b>Medii</b>	Compressed air and all gases or liquids that are compatible with the materials
<b>Domeniu de temperaturi</b>	-20 °C to +80 °C
<b>Suprafață de etanșare</b>	Parallel version: O-ring in housing, Conical version: thread coating
<b>Material</b>	Plastic, Nickel plated brass
<b>Inel de presiune</b>	Plastic

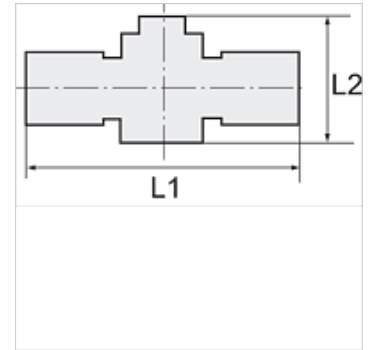

## Indicație

Alte date sunt disponibile la cerere.

## Descriere

Push-in fittings series manufactured in plastic and nickel-plated brass. All parts are suitable for use with hoses, tubes or pipes made of plastic and copper.

## Articol

Denumire	pentru Ø exterior furtun	L1 (mm)	L2 (mm)
K- 07 40 07 73	6 mm	50,8	42,2
K- 07 40 07 74	8 mm	51,8	42,3
K- 07 40 07 75	10 mm	63,3	46,7
K- 07 40 07 76	12 mm	64,1	46,8