

K-L-STECKVER DREH AG-K BESCH 1

Male elbows, swivel type, conical male thread, coated

HANSA FLEX

Caracteristici

Presiune de lucru	Max. 16 bar
Temperatura de lucru	-20 °C to +150 °C
Material	Alamă nichelată
Inel de presiune	Nickel-plated brass
Inel de prindere	Stainless steel

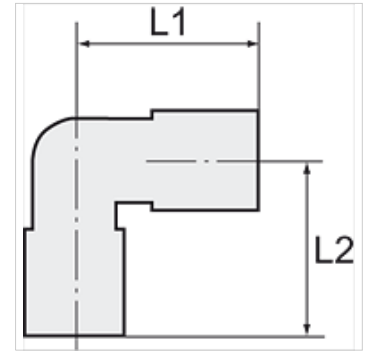

Indicație

Alte date sunt disponibile la cerere.

Descriere

Push-in fittings, manufactured entirely in nickel-plated brass. All parts with a parallel thread are supplied with an FPM O-ring. All parts with conical threads are coated with preCOTE 5 dispersion, all fittings in this series can thus also be used at high temperatures (medium compressed air).

Articol

Denumire	Filet	pentru Ø exterior furtun	L1 (mm)	L2 (mm)	Deschiderea cheii fixe
K- 07 40 28 10	R 1/8	4 mm	20,0	20,0	13 mm
K- 07 40 28 11	R 1/8	6 mm	21,0	20,0	13 mm
K- 07 40 28 12	R 1/8	8 mm	24,0	20,0	13 mm
K- 07 40 28 07	R 1/4	4 mm	20,0	25,0	14 mm
K- 07 40 28 08	R 1/4	6 mm	21,0	25,0	14 mm
K- 07 40 28 09	R 1/4	8 mm	24,0	25,0	14 mm
K- 07 40 28 06	R 1/4	10 mm	27,0	26,0	16 mm
K- 07 40 28 14	R 3/8	8 mm	24,0	28,0	18 mm
K- 07 40 28 13	R 3/8	10 mm	27,0	30,0	18 mm
K- 07 40 48 00	R 3/8	12 mm	29,0	32,5	20 mm
K- 07 40 47 99	R 1/2	12 mm	29,0	35,5	22 mm