

K-W90 STUECK IG AG

90° elbows, female/male

HANSA FLEX

Caracteristici

Presiune de lucru max. 10 bari

Temperatura de lucru Max. 90 °C

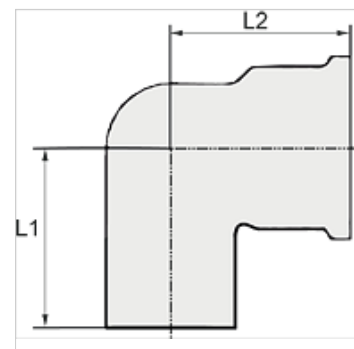

Indicație

Alte date sunt disponibile la cerere.

Articol

Denumire	Filet	L1 (mm)	L2 (mm)
K- 07 40 45 54	G 1/4	28,0	17,5
K- 07 40 45 55	G 3/8	28,0	28,0
K- 07 40 45 56	G 1/2	35,0	35,0
K- 07 40 45 57	G 3/4	38,0	38,0
K- 07 40 45 58	G 1	42,0	42,0
K- 07 40 40 88	G 1 1/4	55,0	55,0
K- 07 40 45 60	G 1 1/2	60,0	60,0
K- 07 40 45 61	G 2	69,0	69,0