

K-ROHRFLANSCH DICHT INFI

Seal for pipe flange

HANSA FLEX

Caracteristici

Material NBR
Carbon fiber

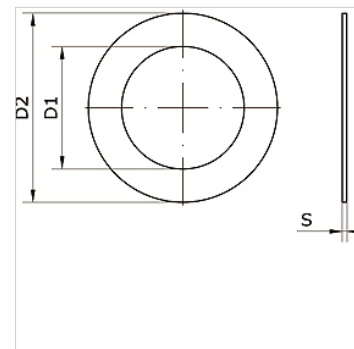

Articol

| Denumire | pentru Ø exterior țeavă mm | D1 (mm) | D2 (mm) | S (mm) |
|----------------|----------------------------|------------|------------|-----------|
| K- 07 40 55 12 | 80 | 89,0 | 131 | 2 |
| K- 07 40 54 59 | 110 | 105,0 | 162 | 2 |