

K-W90 DREH AG OR MS

Male elbows, swivel type, parallel male thread with O-ring (M5 - non-swivel type, w/o O-ring)

HANSA FLEX

Caracteristici

Presiune de lucru Max. 18 bar

Material de etanșare Buna-N

Material Alamă nichelată

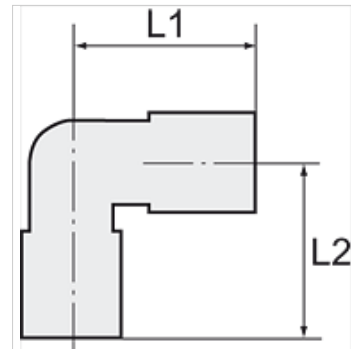

Indicație

Alte date sunt disponibile la cerere.

Articol

Denumire	Filet	pentru furtun	L1 (mm)	L2 (mm)	Deschiderea cheii fixe
K- 07 40 41 30	M 5	5 mm / 3 mm	21,5	15,0	8 mm
K- 07 40 31 48	G 1/8	6 mm / 4 mm	20,5	21,0	13 mm
K- 07 40 31 50	G 1/8	8 mm / 6 mm	21,0	21,0	13 mm
K- 07 40 31 44	G 1/4	6 mm / 4 mm	21,5	22,5	16 mm
K- 07 40 31 46	G 1/4	8 mm / 6 mm	22,0	24,0	16 mm
K- 07 40 31 42	G 1/4	10 mm / 8 mm	24,0	24,0	16 mm