

G AB HB VA

Соединители

HANSA FLEX

Свойства

| | |
|--------------------|-------------------------------------|
| Соединение 1 | Гаечная резьба BSP |
| Форма уплотнения 1 | Наружный конус 60° |
| Соединение 2 | Наружная резьба BSP, цилиндрическая |
| Форма уплотнения 2 | Внутренний конус 60° |
| Модель | Соединители |
| Конструкция | прямые |
| Материал | нержавеющая сталь |

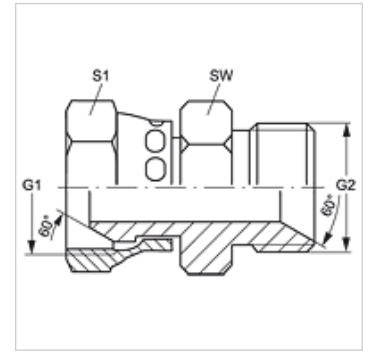

Изделие

| Наименование | G1 | G2 | SW (mm) | S1 |
|------------------|--------------|--------------|------------|----|
| G AB 02 HB VA | G 1/8" -28 | G 1/8" -28 | 14 | 14 |
| G AB 02 HB 04 VA | G 1/8" -28 | G 1/4" -19 | 19 | 19 |
| G AB 04 HB 02 VA | G 1/4" -19 | G 1/8" -28 | 19 | 19 |
| G AB 04 HB VA | G 1/4" -19 | G 1/4" -19 | 19 | 19 |
| G AB 04 HB 06 VA | G 1/4" -19 | G 3/8" -19 | 22 | 19 |
| G AB 04 HB 08 VA | G 1/4" -19 | G 1/2" -14 | 27 | 19 |
| G AB 06 HB 02 VA | G 3/8" -19 | G 1/8" -28 | 22 | 14 |
| G AB 06 HB 04 VA | G 3/8" -19 | G 1/4" -19 | 19 | 22 |
| G AB 06 HB VA | G 3/8" -19 | G 3/8" -19 | 22 | 22 |
| G AB 06 HB 08 VA | G 3/8" -19 | G 1/2" -14 | 27 | 22 |
| G AB 08 HB 04 VA | G 1/2" -14 | G 1/4" -19 | 19 | 27 |
| G AB 08 HB 06 VA | G 1/2" -14 | G 3/8" -19 | 22 | 27 |
| G AB 08 HB VA | G 1/2" -14 | G 1/2" -14 | 27 | 27 |
| G AB 08 HB 12 VA | G 1/2" -14 | G 3/4" -14 | 32 | 27 |
| G AB 12 HB 08 VA | G 3/4" -14 | G 1/2" -14 | 27 | 32 |
| G AB 12 HB VA | G 3/4" -14 | G 3/4" -14 | 32 | 32 |
| G AB 12 HB 16 VA | G 3/4" -14 | G 1" -11 | 41 | 32 |
| G AB 16 HB 12 VA | G 1" -11 | G 3/4" -14 | 41 | 36 |
| G AB 16 HB VA | G 1" -11 | G 1" -11 | 41 | 41 |
| G AB 16 HB 20 VA | G 1" -11 | G 1.1/4" -11 | 41 | 46 |
| G AB 20 HB 16 VA | G 1.1/4" -11 | G 1" -11 | 46 | 41 |
| G AB 20 HB VA | G 1.1/4" -11 | G 1.1/4" -11 | 50 | 50 |
| G AB 24 HB VA | G 1.1/2" -11 | G 1.1/2" -11 | 55 | 55 |
| G AB 32 HB VA | G 2" -11 | G 2" -11 | 70 | 70 |

SW, S1, S2 = размер под ключ

Варианты изделия

G AB HB Соединители, Сталь