

# K-DRS ELK GERAETESTECKER

Pressure switches, connection with plug connector, type A acc. to DIN 43650

**HANSA FLEX**

## Свойства

|                         |                                     |
|-------------------------|-------------------------------------|
| Область применения      | Pneumatic applications              |
| Частота переключений    | 200/min.                            |
| Напряжение переключения | max. 250 V AC / 28 V DC             |
| Степень защиты          | IP 65 (DIN 43650), IP 67 (M 12 x 1) |
| Область температур      | -10 °C to +80 °C                    |
| Регулировочный колпачок | Aluminium, powder-coated            |
| Корпус                  | Special die-cast material           |
| Мембрана, уплотнение    | NBR                                 |

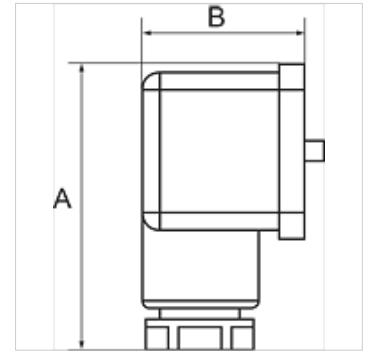

## Указание

Прочие данные только по запросу.

## Описание

For converting pneumatic to electrical signals. Designed for use in rough vacuum applications (technical vacuum). Universal switch type, suitable as NC, NO or changeover contact. These devices are free from paint-wetting impairment substances (PWIS).

## Изделие

| Наименование   | Соединение | Диапазон регулировки | A<br>(mm) | B<br>(mm) |
|----------------|------------|----------------------|-----------|-----------|
| K- 07 30 28 45 | G 1/4      | 0,2 - 2,0 bar        | 48,0      | 28,0      |
| K- 07 30 28 46 | G 1/4      | 0,5 - 8,0 bar        | 48,0      | 28,0      |
| K- 07 30 28 47 | G 1/4      | 1,0 - 16,0 bar       | 48,0      | 28,0      |