

K-W90 DERH AG 1

Male elbows, swivel type, parallel male thread

HANSA FLEX

Свойства

Рабочее давление	Max. 16 bar (at +20 °C)
Рабочая температура	-20 °C to +70 °C
Материал	Никелированная латунь
Прижимное кольцо	Hostaform (black nickel-plated for Ø 10, 12)
Кольцо круглого сечения	NBR, siliconefree
Цанговый зажим	Stainless steel AISI 316

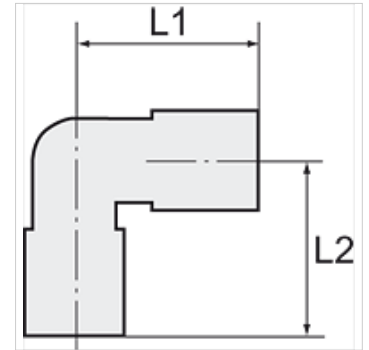

Указание

Прочие данные только по запросу.

Описание

Economy yet very high-quality series of push-in fittings made of nickel-plated brass. Compact, space-saving, lightweight design. An O-ring in the fillet at the end of the thread guarantees a tight connection for all male thread parts, even on rough surfaces.

Изделие

Наименование	Резьба	для наружного Ø шланга	L1 (mm)	L2 (mm)	SW
K- 07 40 29 68	M 5	4 mm	19,0	14,5	9 mm
K- 07 40 29 69	M 5	6 mm	21,0	14,5	9 mm
K- 07 40 29 76	G 1/8	4 mm	19,0	20,0	13 mm
K- 07 40 29 77	G 1/8	6 mm	21,0	20,0	13 mm
K- 07 40 29 78	G 1/8	8 mm	24,0	20,0	13 mm
K- 07 40 29 73	G 1/4	4 mm	19,0	24,0	13 mm
K- 07 40 29 74	G 1/4	6 mm	21,0	24,0	13 mm
K- 07 40 29 75	G 1/4	8 mm	24,0	24,0	13 mm
K- 07 40 29 72	G 1/4	10 mm	27,0	24,0	16 mm
K- 07 40 29 81	G 3/8	8 mm	24,0	25,5	13 mm
K- 07 40 29 79	G 3/8	10 mm	27,0	28,0	16 mm
K- 07 40 29 80	G 3/8	12 mm	28,0	28,5	20 mm
K- 07 40 29 70	G 1/2	10 mm	27,0	30,0	16 mm
K- 07 40 29 71	G 1/2	12 mm	28,0	33,5	20 mm