

K-TUE IG MS

Female hose fittings with female thread

HANSA FLEX

Свойства

| | |
|------------------------------|---------------------------------|
| Рабочее давление | 10 bar |
| Температура среды | max. +90 °C |
| Температура окружающей среды | Max. +90 °C |
| Материал | Brass with a bare metal surface |

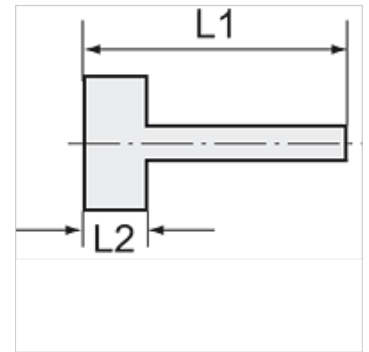
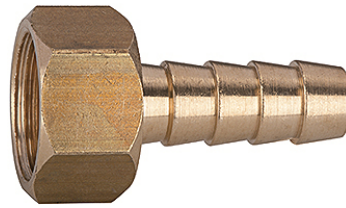

Указание

The dimensions of the standard screw fittings may change slightly during the life of the catalogue as a result of optimisation processes.

Прочие данные только по запросу.

Дополнительная информация

Further types and dimensions on request.

Изделие

| Наименование | Резьба | Для шланга | L1 (mm) | L2 (mm) | SW |
|----------------|--------|------------|------------|------------|-------|
| K- 07 40 13 88 | G 1/8 | LW 6 mm | 35,0 | 10,0 | 12 mm |
| K- 07 40 13 89 | G 1/8 | LW 8 mm | 35,0 | 10,0 | 12 mm |
| K- 07 40 49 76 | G 1/8 | LW 9 mm | 33,5 | 10,5 | 14 mm |
| K- 07 40 13 90 | G 1/4 | LW 6 mm | 36,0 | 11,0 | 15 mm |
| K- 07 40 13 91 | G 1/4 | LW 8 mm | 36,0 | 11,0 | 15 mm |
| K- 07 40 13 92 | G 1/4 | LW 10 mm | 36,0 | 11,0 | 15 mm |
| K- 07 40 13 93 | G 1/4 | LW 13 mm | 40,5 | 11,0 | 15 mm |
| K- 07 40 49 81 | G 1/4 | LW 9 mm | 35,0 | 12,0 | 17 mm |
| K- 07 40 13 94 | G 3/8 | LW 6 mm | 36,0 | 11,0 | 19 mm |
| K- 07 40 13 95 | G 3/8 | LW 8 mm | 36,0 | 11,0 | 19 mm |
| K- 07 40 13 96 | G 3/8 | LW 10 mm | 36,0 | 11,0 | 19 mm |
| K- 07 40 13 97 | G 3/8 | LW 13 mm | 40,5 | 11,0 | 19 mm |
| K- 07 40 49 82 | G 3/8 | LW 9 mm | 36,0 | 13,0 | 19 mm |
| K- 07 40 13 98 | G 1/2 | LW 6 mm | 39,0 | 14,5 | 23 mm |
| K- 07 40 13 99 | G 1/2 | LW 8 mm | 39,0 | 14,5 | 23 mm |
| K- 07 40 14 00 | G 1/2 | LW 10 mm | 39,0 | 14,5 | 23 mm |
| K- 07 40 14 01 | G 1/2 | LW 13 mm | 44,0 | 14,5 | 23 mm |
| K- 07 40 49 83 | G 1/2 | LW 9 mm | 37,0 | 14,0 | 24 mm |
| K- 07 40 49 84 | G 3/4 | LW 13 mm | 39,5 | 16,5 | 30 mm |
| K- 07 40 49 85 | G 3/4 | LW 16 mm | 39,5 | 16,5 | 30 mm |
| K- 07 40 49 86 | G 3/4 | LW 19 mm | 39,5 | 16,5 | 30 mm |
| K- 07 40 49 87 | G 1 | LW 19 mm | 42,5 | 19,5 | 38 mm |
| K- 07 40 49 88 | G 1 | LW 25 mm | 47,0 | 19,5 | 38 mm |