

K-DRGREDV

Pressure reducing valves

Свойства

Входное давление	Max. 15 bar
Соединение	G 1/4 internal / external
Материал	Латунь

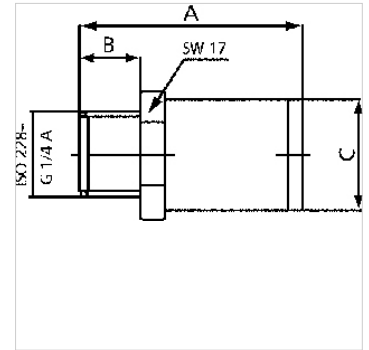
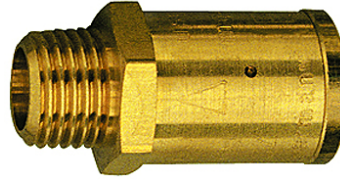

Указание

Dependent on the input pressure P1, the initial pressure P2 can vary between -20% to +20%
Прочие данные только по запросу.

Описание

Industry, trade and repair shops often require working pressures of 15 bar or less. These pressure reducing valves, which are screwed directly onto the tool, enable the actually necessary working pressure to be set.
Benefits: Significantly reduced risk of accidents, Longer tool life with fewer malfunctions, Lower noise levels at the workplace.

Изделие

Наименование	Установочное давление	макс. расход (L/min)	A (mm)	B	Ø C (mm)	SW (mm)
K- 07 25 19 31	2,0	300	34,0	9,0 mm	17,0	17
K- 07 25 02 00	3,0	360	34,0	9,0 mm	17,0	17
K- 07 25 02 01	4,0	380	34,0	9,0 mm	17,0	17
K- 07 25 02 02	5,0	390	34,0	9,0 mm	17,0	17
K- 07 25 02 03	6,0	405	34,0	9,0 mm	17,0	17
K- 07 25 19 32	7,0	415	34,0	9,0 mm	17,0	17
K- 07 25 19 33	8,0	420	34,0	9,0 mm	17,0	17