

K-L-STECK VB 2

Union elbows

HANSA FLEX

Свойства

Рабочее давление Max. 16 bar

Рабочая температура -20 °C to +80 °C

Материал Никелированная латунь

Прижимное кольцо Hostaform

Зажимное кольцо Stainless steel

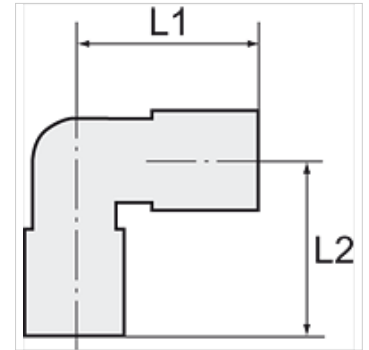

Указание

Прочие данные только по запросу.

Описание

The advanced version of our highly successful push-in fittings series manufactured in nickel-plated brass. Advantages of this new, optimised series: Much easier connection and disconnection of the hose, even with repeated mounting, can also be used for non-calibrated hoses, suitable for vacuum operation.

Изделие

Наименование	для наружного Ø шланга	L1 (mm)	L2 (mm)
K- 07 40 25 34	3 mm	10,4	10,4
K- 07 40 25 35	4 mm	16,7	16,7
K- 07 40 25 36	5 mm	19,2	19,2
K- 07 40 25 37	6 mm	19,0	19,0
K- 07 40 25 38	8 mm	21,3	21,3
K- 07 40 25 39	10 mm	23,3	23,3
K- 07 40 25 40	12 mm	26,0	26,0
K- 07 40 25 41	14 mm	29,3	29,3