

K-DRV 2

Unidirectional flow control valves

HANSA FLEX

Свойства

| | |
|---------------------|------------------------|
| Рабочее давление | макс. 10 бар |
| Рабочая температура | 0 °C to +150 °C |
| Набивочный материал | FKM |
| Корпус | Stainless steel 1.4404 |
| Внутренние детали | Stainless steel 1.4404 |

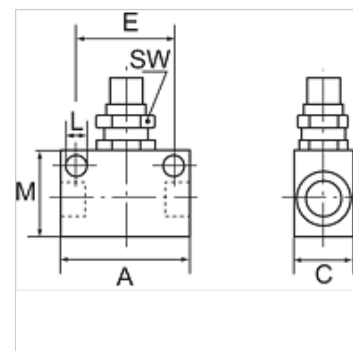
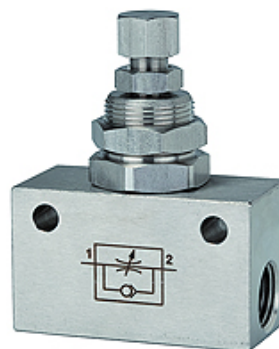

Указание

Прочие данные только по запросу.

Описание

Unidirectional flow control valve, restricted in the flow direction and free passage in the opposite direction.

Изделие

| Наименование | Резьба | A (mm) | C (mm) | E (mm) | L (mm) | M (mm) | SW (mm) |
|----------------|--------|-----------|-----------|-----------|-----------|-----------|------------|
| K- 07 30 12 41 | G 1/8 | 34,0 | 15,0 | 24,0 | 4,5 | 20,0 | 14 |
| K- 07 30 12 42 | G 1/4 | 50,0 | 25,0 | 35,0 | 5,5 | 30,0 | 22 |