

# K-T-MEHRF-VERT 4 DREH 2

Multiple union elbows with inner hex, 4 outlets, swivel type, parallel male thread with O-ring

**HANSA FLEX**

## Свойства

Рабочее давление	Max. 16 bar
Рабочая температура	-20 °C to +80 °C
Материал	Никелированная латунь
Прижимное кольцо	Hostaform
Кольцо круглого сечения	NBR
Зажимное кольцо	Stainless steel

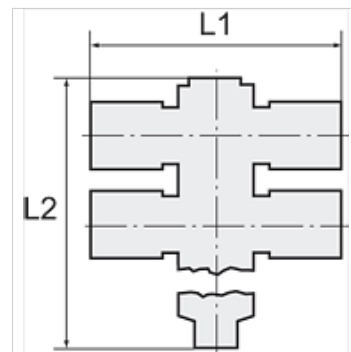

## Указание

Прочие данные только по запросу.

## Описание

The advanced version of our highly successful push-in fittings series manufactured in nickel-plated brass. Advantages of this new, optimised series: Much easier connection and disconnection of the hose, even with repeated mounting, can also be used for non-calibrated hoses, suitable for vacuum operation.

## Изделие

Наименование	Резьба	для наружного Ø шланга	L1 (mm)	L2 (mm)	SW
K- 07 40 26 64	M 5	4 mm	40,4	29,9	2 mm
K- 07 40 26 65	M 5	6 mm	47,0	29,9	2 mm
K- 07 40 26 69	G 1/8	4 mm	40,4	40,9	3 mm
K- 07 40 26 70	G 1/8	6 mm	46,0	41,1	3 mm
K- 07 40 26 71	G 1/8	8 mm	49,6	41,1	3 mm
K- 07 40 26 67	G 1/4	6 mm	49,0	47,0	4 mm
K- 07 40 26 68	G 1/4	8 mm	53,0	47,0	4 mm
K- 07 40 26 66	G 1/4	10 mm	62,8	47,0	4 mm