

K-L-STECKVER DREH AG OR VA

Male elbows, swivel type, parallel male thread with O-ring

Свойства

| | |
|-------------------------------|---|
| Рабочее давление пульсирующее | Max. 10 bar |
| Давление | Max. 15 bar (depending on pipe quality) |
| подходящий материал для труб | PVDF, PTFE, stainless steel, PA, PU |
| Норма | G thread acc. to DIN EN ISO 228-1, with O-Ring |
| Температура окружающей среды | -20 °C to max. +150 °C (depending on pipe quality and diameter) |
| Материал | нержавеющая сталь 1.4404 |
| Набивочный материал | FKM |

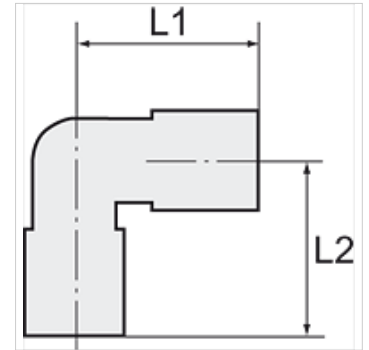
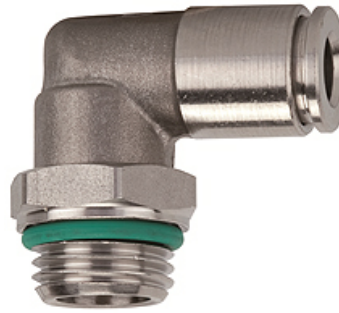

Указание

Прочие данные только по запросу.

Описание

For use with aggressive media and in areas with corrosive outside influences, in the food processing industry and in hygienic and sanitary applications.

Изделие

| Наименование | Резьба | для наружного Ø шланга | L1 (mm) | L2 (mm) | SW |
|----------------|--------|------------------------|------------|------------|-------|
| K- 07 40 46 76 | M 5 | 4 mm | 17,0 | 14,0 | 9 mm |
| K- 07 40 23 91 | G 1/8 | 4 mm | 17,0 | 16,0 | 13 mm |
| K- 07 40 23 93 | G 1/8 | 8 mm | 22,0 | 18,0 | 13 mm |
| K- 07 40 23 92 | G 1/8 | 6 mm | 21,5 | 18,0 | 13 mm |
| K- 07 40 23 89 | G 1/4 | 6 mm | 21,5 | 20,0 | 16 mm |
| K- 07 40 23 90 | G 1/4 | 8 mm | 22,0 | 20,0 | 16 mm |
| K- 07 40 23 88 | G 1/4 | 10 mm | 25,5 | 22,5 | 16 mm |
| K- 07 40 23 94 | G 3/8 | 10 mm | 25,5 | 24,0 | 21 mm |
| K- 07 40 23 95 | G 3/8 | 12 mm | 28,0 | 26,5 | 21 mm |
| K- 07 40 23 87 | G 1/2 | 12 mm | 28,0 | 31,0 | 22 mm |