

K-EINPRESSPATRONE

Press-in sleeves - can only be pressed into plastic

HANSA FLEX

Свойства

Рабочее давление	Max. 15 bar, coarse vacuum
Область применения	Air, vacuum
рекомендуемые шланги	PU or PA (nylon)
Рабочие среды	Compressed air and all gases or liquids that are compatible with the materials
Область температур	-20 °C to +80 °C
Уплотнительная поверхность	Parallel version: O-ring in housing, Conical version: thread coating
Материал	Plastic, Nickel plated brass
Прижимное кольцо	Plastic

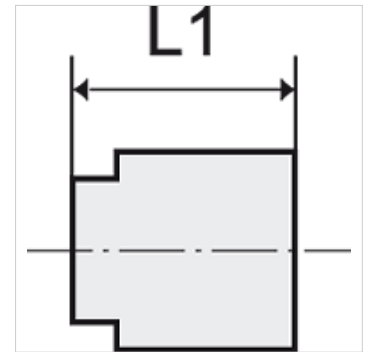
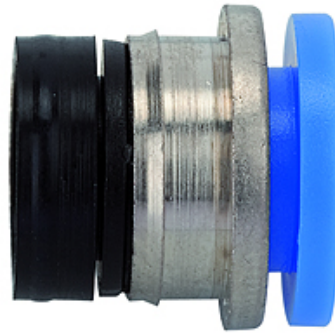

Указание

Only in plastic press-fitted
Прочие данные только по запросу.

Описание

Push-in fittings series manufactured in plastic and nickel-plated brass. All parts are suitable for use with hoses, tubes or pipes made of plastic and copper.

Изделие

Наименование	для наружного Ø шланга	L1 (mm)
K- 07 40 09 95	4 mm	11,3
K- 07 40 09 96	6 mm	11,9
K- 07 40 09 97	8 mm	13,7
K- 07 40 09 98	10 mm	15,2
K- 07 40 09 99	12 mm	17,6