

Vlastnosti

| | |
|--------------------------|--|
| Prípojka 1 | metrický vonkajší závit kužeľový |
| Tvar tesnenia 1 | tesniaci závit |
| Prípojka 2 | metrický vonkajší závit valcový |
| Tvar tesnenia 2 | Vnútrotný kužeľ 24° |
| Konštrukcia | Nákrutka pre naskrutkovanie |
| Vyhotovenie | priame |
| Norma | DIN 2353 ISO 8434-1 |
| Rozsah dodávky | Hrdlo s presuvnou maticou a zárezným krúžkom |
| Materiál | Oceľ |
| Povrchová ochrana | galvanický povlak |

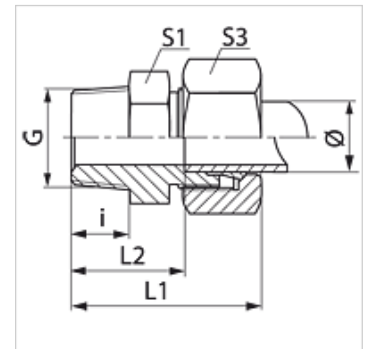

Poznámka

Pokyny pre montáž, zabudovanie, tlakové zaťaženie a povolené prevádzkové teploty nájdete v technických informáciách pre fittingové nákrutky

Výrobok

| Označenie | Konštrukčný rad | Prevádzkový tlak | Rúrka, vonkajší Ø (mm) | G | i (mm) | L1 (mm) | L2 (mm) | S1 | S3 |
|--------------|-----------------|------------------|------------------------|--------------|--------|---------|---------|----|----|
| VM 04 LL | LL | PN 100 | 4 | M 8 x 1 K | 8 | 26,0 | 16,0 | 11 | 10 |
| VM 04 LL 10 | LL | PN 100 | 4 | M 10 x 1 K | 8 | 26,0 | 16,0 | 11 | 10 |
| VM 04 LL 6 | LL | PN 100 | 4 | M 6 x 1 K | 8 | 27,0 | 16,0 | 10 | 10 |
| VM 05 LL | LL | PN 100 | 5 | M 8 x 1 K | 8 | 26,0 | 14,5 | 11 | 12 |
| VM 06 LL | LL | PN 100 | 6 | M 10 x 1 K | 8 | 26,0 | 14,5 | 11 | 12 |
| VM 06 LL 6 | LL | PN 100 | 6 | M 6 x 1 K | 8 | 27,5 | 14,5 | 11 | 12 |
| VM 06 LL 8 | LL | PN 100 | 6 | M 8 x 1 K | 8 | 26,0 | 14,5 | 11 | 12 |
| VM 08 LL | LL | PN 100 | 8 | M 10 x 1 K | 8 | 28,0 | 16,5 | 12 | 14 |
| VM 12 LL | LL | PN 100 | 12 | M 16 x 1,5 K | 12 | 32,0 | 20,0 | 17 | 19 |
| VMK NW 04 HL | D | PN 315 | 6 | M 10 x 1 K | 10 | 23,0 | 17,0 | 12 | 14 |
| VMK NW 06 HL | D | PN 315 | 8 | M 12 x 1,5 K | 12 | 25,0 | 20,0 | 17 | 17 |
| VMK NW 08 HL | D | PN 315 | 10 | M 14 x 1,5 K | 12 | 26,0 | 21,0 | 17 | 19 |
| VMK NW 10 HL | D | PN 315 | 12 | M 16 x 1,5 K | 12 | 27,0 | 22,0 | 19 | 22 |
| VMK NW 13 HL | D | PN 315 | 15 | M 18 x 1,5 K | 12 | 29,0 | 23,0 | 24 | 27 |
| VMK NW 16 HL | D | PN 315 | 18 | M 22 x 1,5 K | 14 | 31,0 | 25,5 | 27 | 32 |
| VMK NW 20 HL | D | PN 160 | 22 | M 26 x 1,5 k | 18 | 33,0 | 31,5 | 32 | 36 |
| VMK NW 25 HL | D | PN 160 | 28 | M 33 x 2 K | 20 | 34,0 | 34,5 | 41 | 41 |
| VMK NW 32 HL | D | PN 160 | 35 | M 42 x 2 K | 21 | 39,0 | 35,5 | 46 | 50 |
| VMK NW 40 HL | D | PN 160 | 42 | M 48 x 2 K | 22 | 42,0 | 38,0 | 55 | 60 |
| VMK NW 03 HS | S | PN 630 | 6 | M 12 x 1,5 K | 12 | 40,0 | 24,0 | 17 | 17 |
| VMK NW 04 HS | S | PN 630 | 8 | M 14 x 1,5 K | 12 | 42,0 | 25,0 | 17 | 19 |
| VMK NW 06 HS | S | PN 630 | 10 | M 16 x 1,5 K | 12 | 43,0 | 24,5 | 19 | 22 |
| VMK NW 08 HS | S | PN 630 | 12 | M 18 x 1,5 K | 12 | 45,0 | 26,5 | 22 | 24 |
| VMK NW 10 HS | S | PN 630 | 14 | M 20 x 1,5 K | 14 | 51,0 | 30,0 | 24 | 27 |
| VMK NW 13 HS | S | PN 400 | 16 | M 22 x 1,5 K | 14 | 51,0 | 31,5 | 27 | 30 |
| VMK NW 16 HS | S | PN 400 | 20 | M 27 x 2 K | 18 | 60,0 | 35,5 | 32 | 36 |
| VMK NW 20 HS | S | PN 400 | 25 | M 33 x 2 K | 20 | 67,0 | 38,0 | 41 | 46 |
| VMK NW 25 HS | S | PN 400 | 30 | M 42 x 2 K | 21 | 71,0 | 40,5 | 56 | 50 |
| VMK NW 32 HS | S | PN 315 | 38 | M 48 x 2 K | 22 | 79,0 | 44,0 | 55 | 60 |

Konštrukčný rad: LL = Veľmi ľahká L = Ľahká S = Ťažká – PN = Menovitý tlak PB = Max. prevádzkový tlak – Ø = Vonkajší priemer rúrky

Varianty produktu

| | |
|---------------|--|
| VMK MG | Nákrutka pre naskrutkovanie, Mosadz |
| VMK VA | Nákrutka pre naskrutkovanie, Ušľachtilá oceľ |
| XVMK | Nákrutka pre naskrutkovanie, Oceľ |