

W90 IN HJ

Hrdlo k naskrutkovaniu, IGN AGJ, uhol 90°

HANSA FLEX

Vlastnosti

| | |
|-------------------|-----------------------|
| Prípojka 1 | Vnútorný závit NPT |
| Tvar tesnenia 1 | tesniaci závit |
| Prípojka 2 | Vonkajší závit UN/UNF |
| Tvar tesnenia 2 | Vonkajší kužeľ 74° |
| Konštrukcia | Hrdlo k privareniu |
| Vyhotovenie | Uhol 90° |
| Materiál | Oceľ |
| Povrchová ochrana | galvanický povlak |

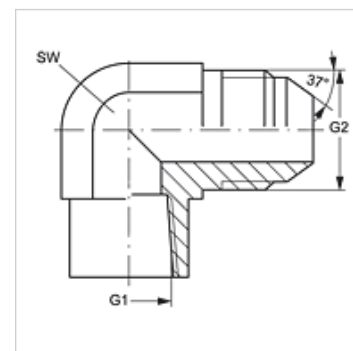

Výrobok

| Označenie | G1 | G2 | SW (mm) |
|-----------------|------------------|----------------|------------|
| W90 IN 02 HJ 04 | 1/8" -27 NPT | 7/16" -20 UNF | 14 |
| W90 IN 02 HJ 05 | 1/8" -27 NPT | 1/2" -20 UNF | 14 |
| W90 IN 02 HJ 06 | 1/8" -27 NPT | 9/16" -18 UNF | 14 |
| W90 IN 04 HJ | 1/4" -18 NPT | 7/16" -20 UNF | 19 |
| W90 IN 04 HJ 05 | 1/4" -18 NPT | 1/2" -20 UNF | 19 |
| W90 IN 04 HJ 06 | 1/4" -18 NPT | 9/16" -18 UNF | 19 |
| W90 IN 04 HJ 08 | 1/4" -18 NPT | 3/4" -16 UNF | 19 |
| W90 IN 06 HJ | 3/8" -18 NPT | 9/16" -18 UNF | 22 |
| W90 IN 06 HJ 08 | 3/8" -18 NPT | 3/4" -16 UNF | 22 |
| W90 IN 08 HJ | 1/2" -14 NPT | 3/4" -16 UNF | 27 |
| W90 IN 08 HJ 10 | 1/2" -14 NPT | 7/8" -14 UNF | 27 |
| W90 IN 08 HJ 12 | 1/2" -14 NPT | 1.1/16" -12 UN | 27 |
| W90 IN 12 HJ | 3/4" -14 NPT | 1.1/16" -12 UN | 33 |
| W90 IN 16 HJ | 1" -11,5 NPT | 1,5/16" -12 UN | 41 |
| W90 IN 20 HJ | 1,1/4" -11,5 NPT | 1,5/8" -12 UN | 48 |
| W90 IN 24 HJ | 1,1/2" -11,5 NPT | 1,7/8" -12 UN | 64 |

SW = Šírka kľúča

Varianty produktu

W90 IN HJ VA Hrdlo k naskrutkovaniu, IGN AGJ, uhol 90°, Ušľachtaná oceľ