

### Vlastnosti

|                          |   |
|--------------------------|---|
| <b>Prípojka 1</b>        | Vonkajší závit NPT                              |
| <b>Tvar tesnenia 1</b>   | tesniaci závit                                  |
| <b>Prípojka 2</b>        | metrický vonkajší závit valcový                 |
| <b>Tvar tesnenia 2</b>   | Vnútny kužeľ 24°                                |
| <b>Konštrukcia</b>       | Nákrutka pre naskrutkovanie                     |
| <b>Vyhotovenie</b>       | Uhol 90°  |
| <b>Norma</b>             | DIN 2353<br>ISO 8434-1                          |
| <b>Rozsah dodávky</b>    | Hrdlo (bez presuvnej matice a zárezného krúžku) |
| <b>Materiál</b>          | Oceľ  |
| <b>Povrchová ochrana</b> | galvanický povlak                               |

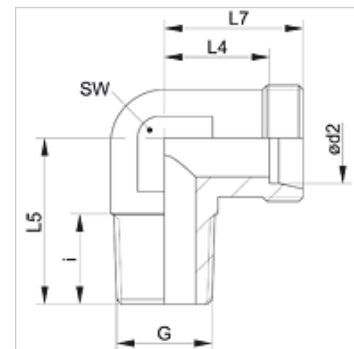

### Poznámka

Pokyny pre montáž, zabudovanie, tlakové zaťaženie a povolené prevádzkové teploty nájdete v technických informáciách pre fittingové nákrutky

### Výrobok

| Označenie        | Konštrukčný rad | Prevádzkový tlak | Rúrka, vonkajší Ø (mm) | G                | i (mm) | L4 (mm) | L5 (mm) | L7 (mm) | SW (mm) |
|------------------|-----------------|------------------|------------------------|------------------|--------|---------|---------|---------|---------|
| XWN 04 LL        | LL              | PN 100           | 4                      | 1/8" -27 NPT     | 8,0    | 11,0    | 17      | 15,0    | 9       |
| XWN 05 LL        | LL              | PN 100           | 5                      | 1/8" -27 NPT     | 8,0    | 11,0    | 17      | 15,0    | 9       |
| XWN 06 LL        | LL              | PN 100           | 6                      | 1/8" -27 NPT     | 8,0    | 9,5     | 17      | 15,0    | 9       |
| XWN 08 LL        | LL              | PN 100           | 8                      | 1/8" -27 NPT     | 10,0   | 11,5    | 20      | 17,0    | 12      |
| XWN NW 04 HL     | D               | PN 315           | 6                      | 1/8" -27 NPT     | 10,0   | 12,0    | 20      | 19,0    | 12      |
| XWN NW 04 HL 1/4 | D               | PN 315           | 6                      | 1/4" -18 NPT     | 12,0   | 14,0    | 26      | 21,0    | 12      |
| XWN NW 04 HL 1/2 | D               | PN 315           | 6                      | 1/2" -14 NPT     | 17,0   | 23,0    | 34      | 30,0    | 19      |
| XWN NW 06 HL     | D               | PN 315           | 8                      | 1/4" -18 NPT     | 12,0   | 14,0    | 26      | 21,0    | 12      |
| XWN NW 06 HL 3/8 | D               | PN 315           | 8                      | 3/8" -18 NPT     | 15,2   | 11,5    | 20      | 18,5    | 12      |
| XWN NW 06 HL 1/2 | D               | PN 315           | 8                      | 1/2" -14 NPT     | 17,5   | 15,0    | 26      | 22,0    | 12      |
| XWN NW 08 HL     | D               | PN 315           | 10                     | 1/4" -18 NPT     | 14,0   | 15,0    | 27      | 22,0    | 14      |
| XWN NW 08 HL 3/8 | D               | PN 315           | 10                     | 3/8" -18 NPT     | 15,2   | 15,0    | 27      | 22,0    | 14      |
| XWN NW 10 HL     | D               | PN 315           | 12                     | 3/8" -18 NPT     | 12,5   | 17,0    | 28      | 24,0    | 17      |
| XWN NW 10 HL 1/4 | D               | PN 315           | 12                     | 1/4" -18 NPT     | 14,0   | 17,0    | 28      | 24,0    | 17      |
| XWN NW 10 HL 1/2 | D               | PN 315           | 12                     | 1/2" -14 NPT     | 19,0   | 23,0    | 34      | 30,0    | 19      |
| XWN NW 13 HL     | D               | PN 315           | 15                     | 1/2" -14 NPT     | 18,5   | 21,0    | 34      | 28,0    | 19      |
| XWN NW 13 HL 3/8 | D               | PN 315           | 15                     | 3/8" -18 NPT     | 13,0   | 21,0    | 34      | 28,0    | 19      |
| XWN NW 16 HL     | D               | PN 315           | 18                     | 1/2" -14 NPT     | 20,0   | 23,5    | 36      | 31,0    | 24      |
| XWN NW 16 HL 3/4 | D               | PN 315           | 18                     | 3/4" -14 NPT     | 18,5   | 23,5    | 40      | 31,0    | 24      |
| XWN NW 20 HL     | D               | PN 160           | 22                     | 3/4" -14 NPT     | 18,5   | 27,5    | 42      | 35,0    | 27      |
| XWN NW 25 HL     | D               | PN 160           | 28                     | 1" -11,5 NPT     | 24,0   | 30,5    | 48      | 38,0    | 36      |
| XWN NW 32 HL     | D               | PN 160           | 35                     | 1,1/4" -11,5 NPT | 25,5   | 34,5    | 54      | 45,0    | 41      |
| XWN NW 40 HL     | D               | PN 160           | 42                     | 1,1/2" -11,5 NPT | 26,0   | 40,0    | 61      | 51,0    | 50      |
| XWN NW 03 HS     | S               | PN 630           | 6                      | 1/4" -18 NPT     | 12,0   | 16,0    | 26      | 23,0    | 12      |
| XWN NW 04 HS     | S               | PN 630           | 8                      | 1/4" -18 NPT     | 15,0   | 17,0    | 27      | 24,0    | 14      |
| XWN NW 06 HS     | S               | PN 630           | 10                     | 3/8" -18 NPT     | 12,0   | 17,5    | 28      | 25,0    | 17      |
| XWN NW 08 HS     | S               | PN 630           | 12                     | 3/8" -18 NPT     | 12,5   | 21,5    | 28      | 29,0    | 17      |
| XWN NW 10 HS     | S               | PN 630           | 14                     | 1/2" -14 NPT     | 18,0   | 22,0    | 34      | 30,0    | 19      |
| XWN NW 13 HS     | S               | PN 400           | 16                     | 1/2" -14 NPT     | 19,0   | 24,5    | 36      | 33,0    | 24      |
| XWN NW 13 HS 3/4 | S               | PN 400           | 16                     | 3/4" -14 NPT     | 20,0   | 24,5    | 40      | 33,0    | 24      |
| XWN NW 16 HS     | S               | PN 400           | 20                     | 3/4" -14 NPT     | 20,0   | 26,6    | 42      | 37,0    | 27      |
| XWN NW 20 HS     | S               | PN 400           | 25                     | 1" -11,5 NPT     | 24,0   | 30,0    | 48      | 42,0    | 36      |
| XWN NW 25 HS     | S               | PN 400           | 30                     | 1,1/4" -11,5 NPT | 25,5   | 35,5    | 54      | 49,0    | 41      |
| XWN NW 32 HS     | S               | PN 315           | 38                     | 1,1/2" -11,5 NPT | 26,0   | 41,0    | 61      | 57,0    | 50      |

Konštrukčný rad: LL = Veľmi ľahká L = Ľahká S = Ťažká – PN = Menovitý tlak PB = Max. prevádzkový tlak – Ø d2 = Vonkajší priemer rúry

### Variety produktu

|               |  |
|---------------|--|
| <b>XWN VA</b> | Nákrutka k naskrutkovaniu, uhol 90°, Ušľachtilá oceľ |
| <b>WN</b>     | Nákrutka k naskrutkovaniu, uhol 90°, Oceľ            |