

### Vlastnosti

<b>Prípojka 1</b>	Vnútorný závit NPT
<b>Tvar tesnenia 1</b>	tesniaci závit
<b>Prípojka 2</b>	Vnútorný závit NPT
<b>Tvar tesnenia 2</b>	tesniaci závit
<b>Konštrukcia</b>	Spojovacia vsuvka
<b>Vyhotovenie</b>	priame
<b>Materiál</b>	Oceľ

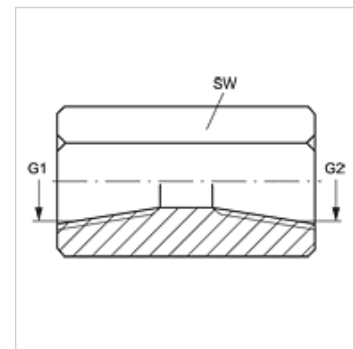

### Výrobok

Označenie	G1	G2	SW (mm)
<b>G IN 02</b>	1/8" -27 NPT	1/8" -27 NPT	16
<b>G 04 IN 02</b>	1/4" -18 NPT	1/8" -27 NPT	19
<b>G IN 04</b>	1/4" -18 NPT	1/4" -18 NPT	19
<b>G 06 IN 04</b>	3/8" -18 NPT	1/4" -18 NPT	22
<b>G IN 06</b>	3/8" -18 NPT	3/8" -18 NPT	22
<b>G 08 IN 04</b>	1/2" -14 NPT	1/4" -18 NPT	29
<b>G 08 IN 06</b>	1/2" -14 NPT	3/8" -18 NPT	29
<b>G IN 08</b>	1/2" -14 NPT	1/2" -14 NPT	30
<b>G 12 IN 08</b>	3/4" -14 NPT	1/2" -14 NPT	36
<b>G IN 12</b>	3/4" -14 NPT	3/4" -14 NPT	36
<b>G 16 IN 12</b>	1" -11,5 NPT	3/4" -14 NPT	46
<b>G IN 16</b>	1" -11,5 NPT	1" -11,5 NPT	46
<b>G IN 20</b>	1,1/4" -11,5 NPT	1,1/4" -11,5 NPT	51
<b>G IN 24</b>	1,1/2" -11,5 NPT	1,1/2" -11,5 NPT	60
<b>G IN 32</b>	2" -11,5 NPT	2" -11,5 NPT	73

SW = Šírka kľúča

### Varianty produktu

**G IN VA** Pripojovacie hrdlo, Ušľachtilá oceľ