

K-SCHLAUCHTUELLEN MS

Hose fittings

HANSA FLEX

Vlastnosti

Pracovný tlak	10 bar
Teplota média	max. +90 °C
Teplota okolia	Max. +90 °C
Materiál	Mosadz

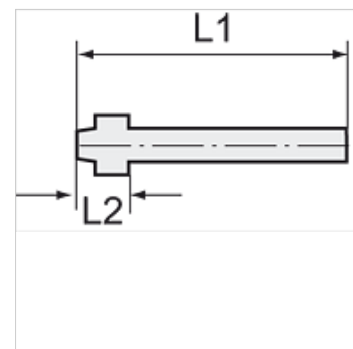

Poznámka

The dimensions of the standard screw fittings may change slightly during the life of the catalogue as a result of optimisation processes.

Ďalšie údaje na vyžiadanie.

Dodatočné informácie

Further types and dimensions on request.

Výrobok

Označenie	pre hadicu	pre presuvnú maticu	L1 (mm)	L2 (mm)
K- 07 40 16 61	LW 4 mm	G 1/8	47,0	12,0
K- 07 40 16 52	LW 4 mm	G 1/4	47,0	13,5
K- 07 40 16 54	LW 9 mm	G 1/4	47,0	13,5
K- 07 40 16 55	LW 4 mm	G 3/8	48,5	15,0
K- 07 40 16 58	LW 6 mm	G 1/2	48,5	15,0
K- 07 40 16 60	LW 13 mm	G 1/2	48,5	15,0