

K-L-STECKVER ABSP DREH AG-K

Angle stop valves, swivel type, conical male thread, coated

HANSA FLEX

Vlastnosti

Pracovný tlak	Max. 10 bar, vacuum
Oblasť použitia	Air, vacuum
odporúčané hadice	PU or PA (nylon)
Médiá	Tlakový vzduch
Norma	R thread acc. to ISO 7-1, thread coating
Rozsah teplôt	0 °C to +60 °C
Tesniaca plocha	Conical version: thread coating
Materiál	Plastic, Nickel plated brass
Prítláčny krúžok	Plastic

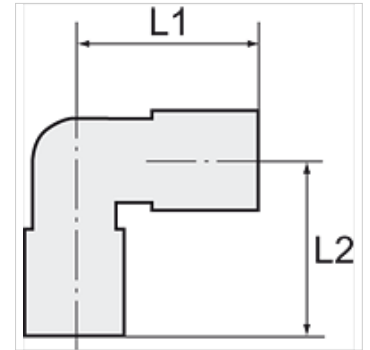

Poznámka

Ďalšie údaje na vyžiadanie.

Popis

The air supply is completely shut off as soon as the hose is disconnected from the union.
The flow rate is only guaranteed if the hose is securely inserted.

Výrobok

Označenie	Závit	pre vonkajší Ø hadice	L1 (mm)	L2 (mm)	SW
K- 07 40 08 53	R 1/8	4 mm	31,0	23,8	10 mm
K- 07 40 08 54	R 1/8	6 mm	29,4	24,2	12 mm
K- 07 40 08 55	R 1/8	8 mm	33,0	27,5	14 mm
K- 07 40 08 51	R 1/4	6 mm	29,4	26,7	14 mm
K- 07 40 08 52	R 1/4	8 mm	33,0	29,5	14 mm
K- 07 40 08 50	R 1/4	10 mm	42,5	34,3	17 mm
K- 07 40 08 58	R 3/8	8 mm	33,0	31,0	17 mm
K- 07 40 08 56	R 3/8	10 mm	42,5	35,3	17 mm
K- 07 40 08 57	R 3/8	12 mm	46,5	37,0	21 mm
K- 07 40 08 48	R 1/2	10 mm	42,5	38,8	21 mm
K- 07 40 08 49	R 1/2	12 mm	46,5	40,0	21 mm