

K-TUE IG MS NI

Female stems with parallel female thread - nickel-plated brass

HANSA FLEX

Vlastnosti

| | |
|---------------------|----------------------|
| Prevádzková teplota | Max. 150 °C |
| Tlak | Max. 60 bar |
| Materiál | Mosadzný poniklovaný |

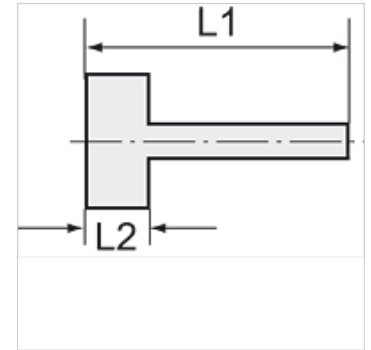
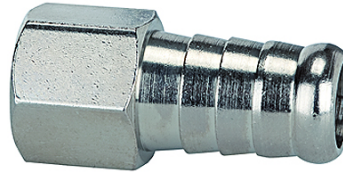

Poznámka

The dimensions of the standard screw fittings may change slightly during the life of the catalogue as a result of optimisation processes.
Ďalšie údaje na vyžiadanie.

Popis

Suitable for air, water, oil, steam, etc.

Dodatočné informácie

Further types and dimensions on request.

Výrobok

| Označenie | Závit | pre hadicu | L1 (mm) | L2 (mm) | SW |
|----------------|-------|------------|------------|------------|-------|
| K- 07 40 11 76 | G 1/8 | LW 6 mm | 28,0 | 8,5 | 12 mm |
| K- 07 40 11 77 | G 1/8 | LW 8 mm | 28,0 | 8,5 | 12 mm |
| K- 07 40 11 78 | G 1/8 | LW 9 mm | 28,0 | 8,5 | 12 mm |
| K- 07 40 11 79 | G 1/8 | LW 10 mm | 28,0 | 8,5 | 12 mm |
| K- 07 40 11 80 | G 1/4 | LW 6 mm | 33,0 | 10,0 | 15 mm |
| K- 07 40 11 81 | G 1/4 | LW 8 mm | 33,0 | 10,0 | 15 mm |
| K- 07 40 11 82 | G 1/4 | LW 9 mm | 33,0 | 10,0 | 15 mm |
| K- 07 40 11 83 | G 1/4 | LW 10 mm | 33,0 | 10,0 | 15 mm |
| K- 07 40 11 84 | G 1/4 | LW 12 mm | 33,0 | 10,0 | 15 mm |
| K- 07 40 11 85 | G 3/8 | LW 8 mm | 35,0 | 12,0 | 19 mm |
| K- 07 40 11 86 | G 3/8 | LW 10 mm | 35,0 | 12,0 | 19 mm |
| K- 07 40 11 87 | G 3/8 | LW 12 mm | 35,0 | 12,0 | 19 mm |
| K- 07 40 11 88 | G 3/8 | LW 14 mm | 35,0 | 12,0 | 19 mm |
| K- 07 40 11 89 | G 1/2 | LW 10 mm | 38,0 | 14,0 | 25 mm |
| K- 07 40 11 90 | G 1/2 | LW 12 mm | 41,0 | 14,0 | 25 mm |
| K- 07 40 11 91 | G 1/2 | LW 14 mm | 41,0 | 14,0 | 25 mm |