

K-SCHOTT-STECKVERB ABSP

Female bulkhead stop unions (pressure max. 10 bar)

HANSA FLEX

Vlastnosti

Pracovný tlak	Max. 10 bar, vacuum
Oblasť použitia	Air, vacuum
odporované hadice	PU or PA (nylon)
Médiá	Tlakový vzduch
Norma	M thread acc. to DIN 13-1, with O-Ring
Rozsah teplôt	0 °C to +60 °C
Materiál	Plastic, Nickel plated brass
Prítlačný krúžok	Plastic

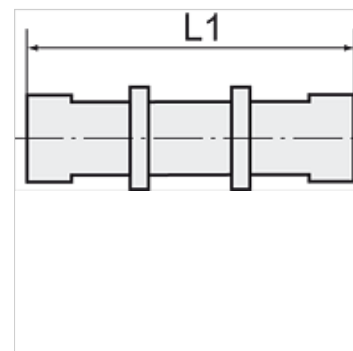
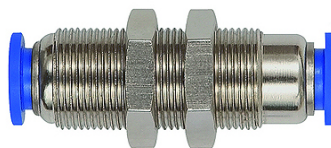

Poznámka

Ďalšie údaje na vyžiadanie.

Popis

The air supply is completely shut off as soon as the hose is disconnected from the union. The flow rate is only guaranteed if the hose is securely inserted.

Výrobok

Označenie	Závit	pre vonkajší Ø hadice	L1 (mm)	SW
K- 07 40 43 74	M 12 x 1,5	4 mm	41,0	14 mm
K- 07 40 43 75	M 14 x 1,5	6 mm	44,5	17 mm
K- 07 40 43 76	M 16 x 1,5	8 mm	50,3	19 mm
K- 07 40 43 77	M 20 x 1,5	10 mm	58,5	24 mm
K- 07 40 43 78	M 24 x 1,5	12 mm	62,2	27 mm