

K-W90 SVB POLYPROPYLEN

Bulkhead elbow couplings - polypropylene

HANSA FLEX

Vlastnosti

Prevádzkový tlak	Dependent on operating temperature; Max. 10 bar (at 20 °C); Max. 2.5 bar (at 90 °C)
Materiál	Polypropylene (PP)
Prevádzková teplota	Max. 90 °C

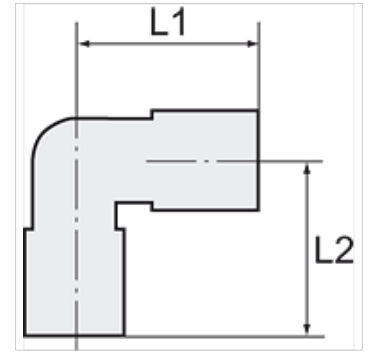
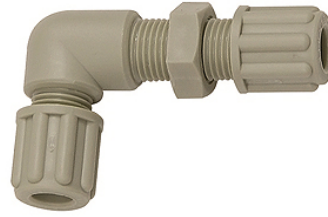

Poznámka

Ďalšie údaje na vyžiadanie.

Popis

Chemically resistant to almost all inorganic acids and bases, even in high concentrations and at temperatures greater than 90 °C.

Výrobok

Označenie	pre hadicu	Závit	L1 (mm)	L2 (mm)	SW
K- 07 40 41 75	4 mm / 6 mm	M 10 x 1	43,0	25,0	14 mm
K- 07 40 41 76	6 mm / 8 mm	M 14 x 1,5	53,0	33,0	19 mm
K- 07 40 41 77	8 mm / 10 mm	M 16 x 1,5	58,0	36,0	22 mm
K- 07 40 41 78	9 mm / 12 mm	M 18 x 1,5	67,0	43,0	24 mm