

K-L-STECKVER DREH AG OR VA

Male elbows, swivel type, parallel male thread with O-ring

HANSA FLEX

Vlastnosti

Pracovný tlak impulzný	Max. 10 bar
Tlak	Max. 15 bar (depending on pipe quality)
vhodný materiál rúrky	PVDF, PTFE, stainless steel, PA, PU
Norma	G thread acc. to DIN EN ISO 228-1, with O-Ring
Teplota okolia	-20 °C to max. +150 °C (depending on pipe quality and diameter)
Materiál	Ušľachtilá oceľ 1.4404
Tesniaci materiál	FKM

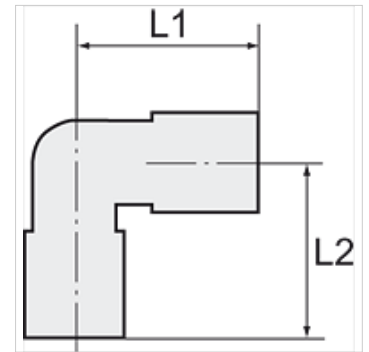

Poznámka

Ďalšie údaje na vyžiadanie.

Popis

For use with aggressive media and in areas with corrosive outside influences, in the food processing industry and in hygienic and sanitary applications.

Výrobok

Označenie	Závit	pre vonkajší Ø hadice	L1 (mm)	L2 (mm)	SW
K- 07 40 46 76	M 5	4 mm	17,0	14,0	9 mm
K- 07 40 23 91	G 1/8	4 mm	17,0	16,0	13 mm
K- 07 40 23 93	G 1/8	8 mm	22,0	18,0	13 mm
K- 07 40 23 92	G 1/8	6 mm	21,5	18,0	13 mm
K- 07 40 23 89	G 1/4	6 mm	21,5	20,0	16 mm
K- 07 40 23 90	G 1/4	8 mm	22,0	20,0	16 mm
K- 07 40 23 88	G 1/4	10 mm	25,5	22,5	16 mm
K- 07 40 23 94	G 3/8	10 mm	25,5	24,0	21 mm
K- 07 40 23 95	G 3/8	12 mm	28,0	26,5	21 mm
K- 07 40 23 87	G 1/2	12 mm	28,0	31,0	22 mm