

# K-SCHOTT-STECKVERB 4

Female bulkhead connectors

**HANSA FLEX**

## Vlastnosti

|                     |                      |
|---------------------|----------------------|
| Pracovný tlak       | Max. 16 bar          |
| Prevádzková teplota | -20 °C to +80 °C     |
| Materiál            | Mosadzný poniklovaný |
| Prítlačný krúžok    | Hostaform            |
| napínací krúžok     | Stainless steel      |

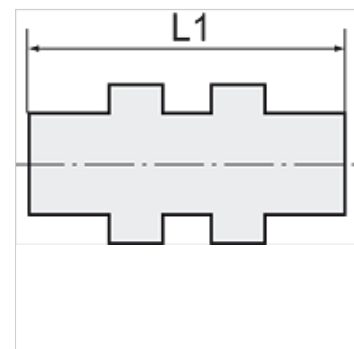
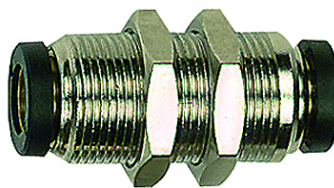

## Poznámka

Ďalšie údaje na vyžiadanie.

## Popis

The advanced version of our highly successful push-in fittings series manufactured in nickel-plated brass. Advantages of this new, optimised series: Much easier connection and disconnection of the hose, even with repeated mounting, can also be used for non-calibrated hoses, suitable for vacuum operation.

## Výrobok

| Označenie      | Závit      | pre vonkajší Ø hadice | L1<br>(mm) | SW    |
|----------------|------------|-----------------------|------------|-------|
| K- 07 40 47 16 | M 8 x 0.75 | 3 mm                  | 18,4       | 10 mm |
| K- 07 40 25 50 | M 11 x 1   | 4 mm                  | 30,6       | 13 mm |
| K- 07 40 25 52 | M 14 x 1   | 5 mm                  | 33,5       | 17 mm |
| K- 07 40 25 53 | M 13 x 1   | 6 mm                  | 33,0       | 16 mm |
| K- 07 40 25 56 | M 15 x 1   | 8 mm                  | 35,7       | 17 mm |
| K- 07 40 25 59 | M 17 x 1   | 10 mm                 | 39,2       | 20 mm |
| K- 07 40 25 60 | M 20 x 1   | 12 mm                 | 40,7       | 24 mm |
| K- 07 40 25 61 | M 24 x 1   | 14 mm                 | 45,9       | 27 mm |