

K-STECKNIPPEL

push-in plug

HANSA FLEX

Vlastnosti

| | |
|---------------------|----------------------|
| Pracovný tlak | Max. 16 bar |
| Prevádzková teplota | -20 °C to +80 °C |
| Materiál | Mosadzný poniklovaný |

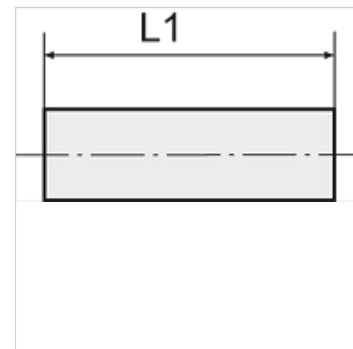
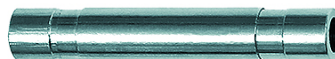

Poznámka

Ďalšie údaje na vyžiadanie.

Popis

The advanced version of our highly successful push-in fittings series manufactured in nickel-plated brass. Advantages of this new, optimised series: Much easier connection and disconnection of the hose, even with repeated mounting, can also be used for non-calibrated hoses, suitable for vacuum operation.

Výrobok

| Označenie | pre vonkajší Ø hadice | L1 (mm) |
|----------------|-----------------------|------------|
| K- 07 40 47 53 | 4 mm | 34,0 |
| K- 07 40 47 54 | 5 mm | 34,0 |
| K- 07 40 47 55 | 6 mm | 37,5 |
| K- 07 40 47 56 | 8 mm | 37,5 |
| K- 07 40 47 57 | 10 mm | 45,0 |
| K- 07 40 47 58 | 12 mm | 48,0 |
| K- 07 40 47 59 | 14 mm | 58,0 |