

# K-Y-STECK VERSCH DREH AG-K

Male branch Y-fittings, swivel type, conical male thread, coated

**HANSA FLEX**

## Vlastnosti

|                   |  |
|-------------------|--|
| Pracovný tlak     | Max. 15 bar, coarse vacuum   |
| Oblasť použitia   | Air, vacuum  |
| odporučené hadice | PU or PA (nylon)   |
| Médiá             | Compressed air and all gases or liquids that are compatible with the materials |
| Rozsah teplôt     | -20 °C to +80 °C   |
| Tesniaca plocha   | Conical version: thread coating  |
| Materiál          | Plastic, Nickel plated brass   |
| Prítláčny krúžok  | Plastic  |

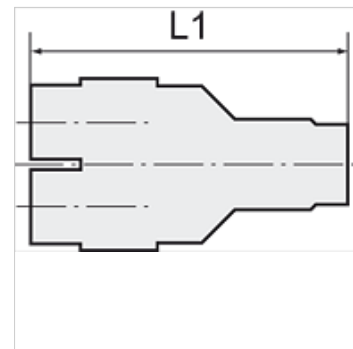

## Poznámka

Ďalšie údaje na vyžiadanie.

## Popis

Push-in fittings series manufactured in plastic and nickel-plated brass. All parts are suitable for use with hoses, tubes or pipes made of plastic and copper.

## Výrobok

| Označenie      | Závit | pre vonkajší Ø hadice | L1<br>(mm) | SW    |
|----------------|-------|-----------------------|------------|-------|
| K- 07 40 03 31 | R 1/8 | 4 mm                  | 42,0       | 10 mm |
| K- 07 40 03 32 | R 1/8 | 6 mm                  | 43,5       | 12 mm |
| K- 07 40 03 33 | R 1/8 | 8 mm                  | 46,8       | 14 mm |
| K- 07 40 03 29 | R 1/8 | 10 mm                 | 56,0       | 17 mm |
| K- 07 40 03 30 | R 1/8 | 12 mm                 | 59,8       | 21 mm |
| K- 07 40 03 26 | R 1/4 | 4 mm                  | 45,0       | 14 mm |
| K- 07 40 03 27 | R 1/4 | 6 mm                  | 46,0       | 14 mm |
| K- 07 40 03 28 | R 1/4 | 8 mm                  | 48,8       | 14 mm |
| K- 07 40 03 24 | R 1/4 | 10 mm                 | 58,0       | 17 mm |
| K- 07 40 03 25 | R 1/4 | 12 mm                 | 61,8       | 21 mm |
| K- 07 40 03 37 | R 3/8 | 6 mm                  | 47,5       | 17 mm |
| K- 07 40 03 38 | R 3/8 | 8 mm                  | 50,3       | 17 mm |
| K- 07 40 03 34 | R 3/8 | 10 mm                 | 59,0       | 17 mm |
| K- 07 40 03 35 | R 3/8 | 12 mm                 | 62,8       | 21 mm |
| K- 07 40 03 36 | R 3/8 | 16 mm                 | 72,0       | 24 mm |
| K- 07 40 03 22 | R 1/2 | 6 mm                  | 51,0       | 21 mm |
| K- 07 40 03 23 | R 1/2 | 8 mm                  | 53,8       | 21 mm |
| K- 07 40 03 19 | R 1/2 | 10 mm                 | 62,5       | 21 mm |
| K- 07 40 03 20 | R 1/2 | 12 mm                 | 65,8       | 21 mm |
| K- 07 40 03 21 | R 1/2 | 16 mm                 | 75,0       | 24 mm |