

K-2-BK V DURCHG INFI

2/2-way ball valve Ø 20 mm - Ø 63 mm full bore

HANSA FLEX

Vlastnosti

| | |
|------------------|-------------------------------------|
| Médiá | Compressed air, vacuum, inert gases |
| Prevádzkový tlak | -0,99 bar - 15 bar |
| Rozsah teplôt | -20 °C to +80 °C |
| tesnenie | NBR |
| Kryt | Nickel-plated brass |
| zvierací krúžok | Stainless steel 1.4301 |
| matica | Aluminium |
| O-krúžok | NBR |
| poistný krúžok | Technopolymer |

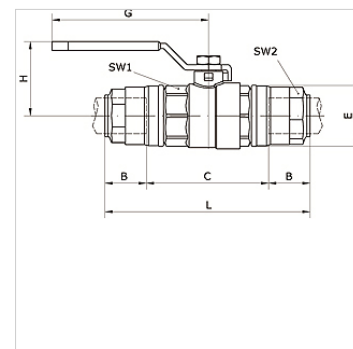

Výrobok

| Označenie | Vonkajší Ø rúrky | B (mm) | C (mm) | DN | E (mm) | G (mm) | V (mm) | D (mm) | SW1 (mm) | SW2 (mm) |
|----------------|------------------|-----------|-----------|----|-----------|-----------|-----------|-----------|-------------|-------------|
| K- 07 40 55 05 | 63 mm | 57,5 | 38,0 | 59 | 94,0 | 240 | 111,5 | 232,0 | 89 | 75 |