

K-T-STECK VB 80-100 RED ABG INFI

T-push-in connector Ø 80 mm/Ø 110 mm with reduced outlet and female thread

HANSA FLEX

Vlastnosti

| | |
|----------------------------|-------------------------------------|
| Médiá | Compressed air, vacuum, inert gases |
| Prevádzkový tlak | -0,99 bar - 15 bar |
| Rozsah teplôt | -20 °C to +80 °C |
| vodiaci krúžok | Technopolymer |
| Kryt | Aluminium, treated surface |
| inbusová skrutka | Galvanised steel |
| zvierací krúžok | Stainless steel 1.4301 |
| matica | Aluminium, surface treated |
| O-krúžok | NBR |
| samoistiacia matica | Galvanised steel |
| poistný krúžok | Technopolymer |

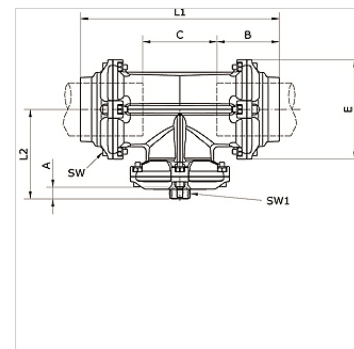
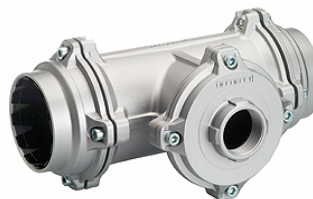

Výrobok

| Označenie | Vonkajší Ø rúrky | Prípojka | A: (mm) | B (mm) | C (mm) | E (mm) | L1 (mm) | L2 (mm) | SW (mm) | SW1 (mm) |
|-----------------------|------------------|----------|------------|-----------|-----------|-----------|------------|------------|------------|-------------|
| K- 07 40 55 21 | 80 - 80 mm | G 3/4 | 14,5 | 91,0 | 109,0 | 145,0 | 291,5 | 138,0 | 6 | 42 |
| K- 07 40 54 68 | 110 - 110 mm | G 3/4 | 14,5 | 125,5 | 150,5 | 200,0 | 401,0 | 180,0 | 8 | 42 |