

K-DRUCKVERST VBA

Booster Regulator, VBA

HANSA FLEX

Vlastnosti

| | |
|---------------------------------------|--|
| min. prevádzkový tlak | 0.20 MPa |
| Prípojka pre manometer pneumatická | Rc 1/8 |
| Počet pripojení pneumatický manometer | 2 |
| max. vstupný tlak | 0,1 to 1,0 MPa |
| Teplota média | +2 °C to +50 °C |
| Teplota okolia | +2 °C bis +50 °C |
| Médiá | Tlakový vzduch |
| Ďalšie údaje | increases the pressure only where the force is insufficient due to low factory pressure (measure to save energy) no power supply required extended life: doubled compared to the conventional model improved reliability through built-in strainer on (IN terminal) Compressed air inlet reduced condensation: Venting channels directly integrated in the cylinder tube Reduced noise: 13 dB (A) |

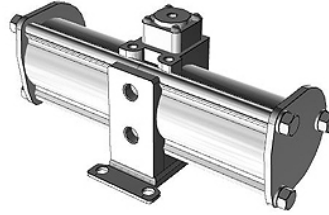

Popis

Booster regulator, series VBA, increases pressure only where the force is inadequate because of a low network pressure (energy saving measure), no electricity supply necessary, longer service life: doubled compared to conventional model, lower operating noise level: 13 dB (A), improved operational reliability from inbuilt mesh filter on (IN connection) compressed air inlet, reduced condensation levels: air exhaust channels integrated directly into the cylinder tube, suitable for: compressed air, size 1/4, with pressure gauge and silencer, elbow, pneumatic connection: G 1/4, pneumatic connection pressure gauge: G 1/8, pneumatic connections pressure gauge: 2, flow rate 230 l/min, pressure boost 1:2, manually actuated pressure adjustment mechanism, test pressure: 3 MPa, max. operating pressure: 2 MPa, min. operating pressure: 0.2 MPa, media temperature: +2 to +50 °C, ambient temperature: +2 to +50 °C

Výrobok

| Označenie | Prípojka pneumatická | Veľkosť | Mechanizmus nastavenia tlaku | Pomer zosilnenia tlaku | Prietok (L/min) | max. prevádzkový tlak (MPa) | Skúšobný tlak (MPa) |
|----------------|----------------------|---------|------------------------------|------------------------|-----------------|-----------------------------|---------------------|
| K- 07 60 00 06 | G 1/4 | 1/4 | manually operated | 1:2 to 1:4 | 70 | 2,00 | 3,00 |
| K- 07 60 00 01 | G 1/4 | 1/4 | manually operated | 1:2 | 230 | 2,00 | 3,00 |
| K- 07 60 00 08 | G 3/8 | 3/8 | manually operated | 1:2 | 1000 | 1,00 | 1,50 |
| K- 07 60 00 12 | G 3/8 | 3/8 | pneumatically actuated | 1:2 | 1000 | 1,00 | 1,50 |
| K- 07 60 00 13 | G 1/2 | 1/2 | manually operated | 1:2 | 1900 | 1,00 | 1,50 |
| K- 07 60 00 14 | G 1/2 | 1/2 | pneumatically actuated | 1:2 | 1900 | 1,00 | 1,50 |
| K- 07 60 00 15 | G 1/2 | 1/2 | manually operated | 1:2 | 1600 | 1,60 | 2,40 |