

WFG JIC (6000 PSI)

Adapter za spojko SAE, kovani

HANSA FLEX

Lastnosti

| | |
|------------------------|-------------------------|
| Tlačna vrsta | 6000 psi |
| Standard | SAE J 518 C ISO 6162 |
| Način izdelave-dodatek | kovano |
| Oblika izdelave | koleno 90° |
| Način izdelave | adapter SAE-prirobnica |
| Obseg dobave | samo prirobnica |
| Material: | S355J2G3 (ST52.3) |
| Zaščita površine | galvanično prevlečeno |

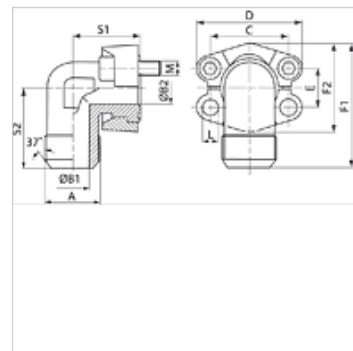
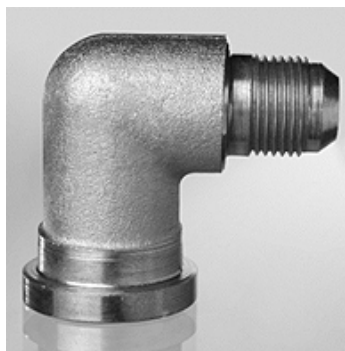

Navodilo

Navedeni najvišji obratovalni tlak velja za prirobnico! Dejanski obratovalni tlak se določa na osnovi cevi (debeline stene) in na osnovi kvalitete cevi!

Priporočeni vijaki so navedeni v stolpcih M (metr) ali M (unc).

Artikel

| Opis | PB 10.9 (bar) | Velikost | A | B1 (mm) | B2 (mm) | E (mm) | F1 (mm) | S1 (mm) | S2 (mm) | L (mm) | M metr. | M unc |
|---------------------|---------------|----------|-------------|---------|---------|--------|---------|---------|---------|--------|-----------|----------------|
| WFG 6001 JIC 3/4 | 400 | 1/2" | UNF 3/4" | 9,9 | 13 | 18,2 | 61,6 | 39 | 38 | 8,7 | M 8 x 30 | 5/16" x 1.1/4" |
| WFG 6001 JIC 7/8 | 400 | 1/2" | UNF 7/8" | 12,3 | 13 | 18,2 | 61,6 | 39 | 38 | 8,7 | M 8 x 35 | 5/16" x 1.1/4" |
| WFG 6002 JIC 1 1/16 | 400 | 3/4" | UNF 1,1/16" | 15,5 | 17 | 23,8 | 78,0 | 48 | 48 | 10,7 | M 10 x 35 | 3/8" x 1.1/2" |
| WFG 6002 JIC 1 5/16 | 400 | 3/4" | UN 1,5/16" | 21,5 | 17 | 23,8 | 78,0 | 48 | 48 | 10,7 | M 10 x 35 | 3/8" x 1.1/2" |
| WFG 6002 JIC 7/8 | 400 | 3/4" | UNF 7/8" | 12,3 | 17 | 23,8 | 78,0 | 48 | 48 | 10,7 | M 10 x 35 | 3/8" x 1.1/2" |
| WFG 6003 JIC 1 1/16 | 400 | 1" | UNF 1,1/16" | 15,5 | 24 | 27,8 | 99,0 | 60 | 60 | *1 | M 12 x 45 | 7/16" x 1.3/4" |
| WFG 6003 JIC 1 5/16 | 400 | 1" | UN 1,5/16" | 21,5 | 24 | 27,8 | 99,0 | 60 | 60 | *1 | M 12 x 45 | 7/16" x 1.3/4" |
| WFG 6003 JIC 1 5/8 | 400 | 1" | UN 1,5/8" | 27,5 | 24 | 27,8 | 99,0 | 60 | 60 | *1 | M 12 x 45 | 7/16" x 1.1/2" |
| WFG 6004 JIC 1 5/16 | 400 | 1.1/4" | UN 1,5/16" | 21,5 | 30 | 31,8 | 115,5 | 68 | 68 | *2 | M 14 x 50 | 1/2" x 1.3/4" |
| WFG 6004 JIC 1 5/8 | 400 | 1.1/4" | UN 1,5/8" | 27,5 | 30 | 31,8 | 115,5 | 68 | 68 | *2 | M 14 x 50 | 1/2" x 1.3/4" |
| WFG 6004 JIC 1 7/8 | 400 | 1.1/4" | UN 1,7/8" | 33,0 | 30 | 31,8 | 115,5 | 68 | 68 | *2 | M 14 x 50 | 1/2" x 1.3/4" |
| WFG 6005 JIC 1 5/8 | 400 | 1.1/2" | UN 1,5/8" | 27,5 | 32 | 36,5 | 133,0 | 76 | 76 | 17,0 | M 16 x 55 | 5/8" x 2" |
| WFG 6005 JIC 1 7/8 | 400 | 1.1/2" | UN 1,7/8" | 33,0 | 32 | 36,5 | 133,0 | 76 | 76 | 17,0 | M 16 x 55 | 5/8" x 2" |

PN = nazivni tlak PB = maks. obratovalni tlak

*1) = izbirno 12,0 ali 12,5 - *2) = izbirno 13,5 ali 14,5

Variante izdelka

WFG JIC U (3000 / 6000 PSI) Adapter za spojko SAE, kovani, z 2 polprirobnicama, kompletom vijakov in O-tesnilom

WFG JIC M (3000 / 6000 PSI) Adapter za spojko SAE, kovani, z 2 polprirobnicama, kompletom vijakov in O-tesnilom