

Lastnosti

Priključek 1	zunanj navoj cilindrični BSP
Oblika tesnila 1	izvedba F
Priključek 2	metrični zunanji navoj, cilindrični
Oblika tesnila 2	24° notranji konus
Način izdelave	obračalni vijačni priključek brez dušenja
Oblika izdelave	koleno 90°
Standard	DIN 2353 ISO 8434-1
Obseg dobave	nastavek s prekrivno matico in rezalnim obročem
Material:	jeklo
Zaščita površine	galvanično prevlečeno

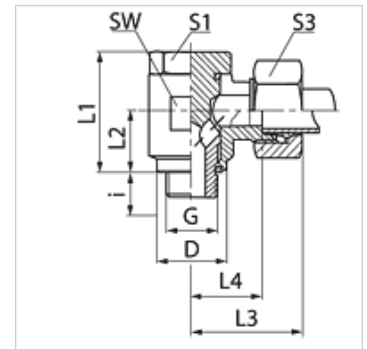

Navodilo

Za navodila za montažo, vgradnjo, obremenitev s tlakom in dovoljene temperature delovanja si, prosimo, oglejte tehnične podatke za navojne cevne priključke.

Artikel

Opis	Serijska	Obratovalni tlak bar	Zunanji Ø cevi (mm)	G	D	i	L1	L2	L3	L4	SW	S1	S3	OR
					(mm)	(mm)	(mm)	(mm)	(mm)	(mm)	(mm)	(mm)	(mm)	
SDOR 04 LL	LL	PN 100	4	G 1/8" -28	14,7	8,0	23,5	10,5	29,0	14,0	17	17	10	7,65 x 1,78
SDOR 06 LL	LL	PN 100	6	G 1/8" -28	13,5	8,0	23,5	10,5	28,5	13,5	17	17	12	7,65 x 1,78
SDOR 08 LL	LL	PN 100	8	G 1/8" -28	14,7	8,0	23,5	10,5	28,5	13,5	17	17	14	7,65 x 1,78
SDOR NW 04 HL	L	PN 315	6	G 1/8" -28	14,0	8,0	24,0	10,5	27,0	12,0	17	17	14	7,65 x 1,78
SDOR NW 06 HL	L	PN 315	8	G 1/4" -19	18,0	12,0	30,0	14,0	29,0	14,5	22	19	17	11,10 x 1,78
SDOR NW 08 HL	L	PN 315	10	G 1/4" -19	18,0	12,0	30,0	14,0	30,0	15,5	22	19	19	11,10 x 1,78
SDOR NW 10 HL	L	PN 315	12	G 3/8" -19	22,0	12,0	36,0	16,5	33,0	18,0	27	24	22	14,00 x 1,78
SDOR NW 13 HL	L	PN 315	15	G 1/2" -14	26,0	14,0	45,0	21,5	37,0	21,5	32	30	27	18,77 x 1,78
SDOR NW 16 HL	L	PN 315	18	G 1/2" -14	26,0	14,0	45,0	21,5	37,0	21,0	32	30	32	18,77 x 1,78
SDOR NW 20 HL	L	PN 160	22	G 3/4" -14	32,0	16,0	53,0	24,0	44,0	27,5	41	36	36	23,81 x 2,62
SDOR NW 25 HL	L	PN 160	28	G 1" -11	39,0	18,0	66,0	30,5	49,0	32,0	50	46	41	29,82 x 2,62
SDOR NW 32 HL	L	PN 160	35	G 1,1/4" -11	49,0	20,0	76,0	35,5	58,0	36,0	60	55	50	37,77 x 2,62
SDOR NW 40 HL	L	PN 160	42	G 1,1/2" -11	55,0	22,0	87,0	40,5	63,0	40,5	70	60	60	41,28 x 3,53
SDOR NW 03 HS	S	PN 400	6	G 1/4" -19	18,0	12,0	30,0	14,0	31,0	16,5	22	19	17	11,10 x 1,78
SDOR NW 04 HS	S	PN 400	8	G 1/4" -19	18,0	12,0	30,0	14,0	31,0	16,5	22	19	19	11,10 x 1,78
SDOR NW 06 HS	S	PN 400	10	G 3/8" -19	22,0	12,0	36,0	16,5	35,0	18,5	27	24	22	14,00 x 1,78
SDOR NW 08 HS	S	PN 400	12	G 3/8" -19	22,0	12,0	36,0	16,5	35,0	18,5	27	24	24	14,00 x 1,78
SDOR NW 10 HS	S	PN 400	14	G 1/2" -14	26,0	14,0	45,0	21,5	40,0	22,5	32	30	27	18,77 x 1,78
SDOR NW 13 HS	S	PN 315	16	G 1/2" -14	26,0	14,0	45,0	21,5	40,0	22,0	32	30	30	18,77 x 1,78
SDOR NW 16 HS	S	PN 315	20	G 3/4" -14	32,0	16,0	53,0	24,0	48,0	26,5	41	36	36	23,81 x 2,62
SDOR NW 20 HS	S	PN 250	25	G 1" -11	39,0	18,0	66,0	30,5	56,0	31,5	50	46	46	29,82 x 2,62
SDOR NW 25 HS	S	PN 160	30	G 1,1/4" -11	49,0	20,0	76,0	35,5	64,0	37,0	60	55	50	37,77 x 2,62
SDOR NW 32 HS	S	PN 160	38	G 1,1/2" -11	55,0	22,0	87,0	40,5	72,0	41,5	70	60	60	41,28 x 3,53

PN = nazivni tlak PB = maks. obratovalni tlak - serija: LL = zelo lahko L = lahko S = težko - Ø d2 = zunanji premer cevi

Variante izdelka

SDOR VA	Vrtljiv vijačni priključek, brez dušenja, kot 90°, nerjavno jeklo
XSDOR	Obračalni vijačni spoj, brez dušenja, kot 90°, jeklo