

Lastnosti

Priključek 1	zunanji navoj cilindrični BSP
Oblika tesnila 1	obroč s tesnilnim robom
Priključek 2	metrični zunanji navoj, cilindrični
Oblika tesnila 2	24° notranji konus
Način izdelave	obračalni vijačni priključek brez dušenja
Oblika izdelave	koleno 90°
Standard	DIN 2353 ISO 8434-1
Obseg dobave	nastavek s prekrivno matico in rezalnim obročem
Material:	jeklo
Zaščita površine	galvanično prevlečeno

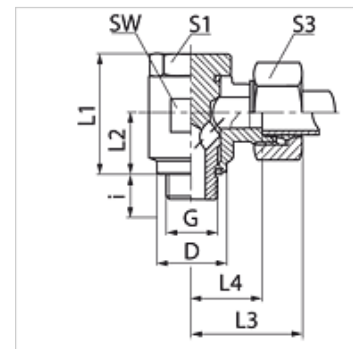

Navodilo

Za navodila za montažo, vgradnjo, obremenitev s tlakom in dovoljene temperature delovanja si, prosimo, oglejte tehnične podatke za navojne cevne priključke.

Artikel

Opis	Serija	Obratovalni tlak bar	Zunanji Ø cevi (mm)	G	D (mm)	i (mm)	L1 (mm)	L2 (mm)	L3 (mm)	L4 (mm)	SW (mm)	S1	S3
SDR NW 04 HL	L	PN 250	6	G 1/8" -28	14,0	8	24	10,5	27	12,0	17	17	14
SDR NW 04 HL 1/4	L	PN 250	6	G 1/4" -19	18,0	12	30	14,0	29	14,5	22	19	14
SDR NW 06 HL	L	PN 250	8	G 1/4" -19	18,0	12	30	14,0	29	14,5	22	19	17
SDR NW 08 HL	L	PN 250	10	G 1/4" -19	18,0	12	30	14,0	30	15,5	22	19	19
SDR NW 10 HL 1/4	L	PN 250	12	G 1/4" -19	22,0	12	30	14,0	30	15,5	22	19	22
SDR NW 10 HL	L	PN 250	12	G 3/8" -19	22,0	12	36	16,5	33	18,0	27	24	22
SDR NW 10 HL 1/2	L	PN 250	12	G 1/2" -14	26,0	14	45	21,5	35	20,5	32	30	22
SDR NW 13 HL	L	PN 250	15	G 1/2" -14	26,0	14	45	21,5	37	21,5	32	30	27
SDR NW 16 HL	L	PN 250	18	G 1/2" -14	26,0	14	45	21,5	37	21,0	32	30	32
SDR NW 20 HL	L	PN 160	22	G 3/4" -14	32,0	16	53	24,0	44	27,5	41	36	36
SDR NW 25 HL	L	PN 160	28	G 1" -11	39,0	18	66	30,5	49	32,0	50	46	41
SDR NW 32 HL	L	PN 160	35	G 1,1/4" -11	49,0	20	76	35,5	58	36,0	60	55	50
SDR NW 40 HL	L	PN 160	42	G 1,1/2" -11	55,0	22	87	40,5	63	40,5	70	60	60
SDR NW 03 HS	S	PN 315	6	G 1/4" -19	18,0	12	30	14,0	31	16,5	22	19	17
SDR NW 04 HS	S	PN 315	8	G 1/4" -19	18,0	12	30	14,0	31	16,5	22	19	19
SDR NW 06 HS	S	PN 315	10	G 3/8" -19	22,0	12	36	16,5	35	18,5	27	24	22
SDR NW 08 HS	S	PN 315	12	G 3/8" -19	22,0	12	36	16,5	35	18,5	27	24	24
SDR NW 10 HS	S	PN 315	14	G 1/2" -14	26,0	14	45	21,5	40	22,5	32	30	27
SDR NW 13 HS	S	PN 315	16	G 1/2" -14	26,5	14	45	21,5	40	22,0	32	30	30
SDR NW 16 HS	S	PN 160	20	G 3/4" -14	32,0	16	53	24,0	48	26,5	41	36	36
SDR NW 20 HS	S	PN 160	25	G 1" -11	39,0	18	66	30,5	56	31,5	50	46	46
SDR NW 25 HS	S	PN 160	30	G 1,1/4" -11	49,0	20	76	35,5	64	37,0	60	55	50
SDR NW 32 HS	S	PN 160	38	G 1,1/2" -11	55,0	22	87	40,5	72	41,5	70	60	60

PN = nazivni tlak PB = maks. obratovalni tlak - serija: LL = zelo lahko L = lahko S = težko - Ø = zunanji premer cevi

Variante izdelka

XSDR