

**Lastnosti**

|                           |   |
|---------------------------|---|
| <b>Način izdelave</b>     | Strgalo   |
| <b>Drсна hitrost max.</b> | 0,5 m/s   |
| <b>Temperatura min.</b>   | -40 °C  |
| <b>Temperatura max.</b>   | 130 °C  |
| <b>Sredstva</b>           | Mineralna olja<br>vodne emulzije                        |
| <b>Montaža</b>            | strgalo ukrivite v obliki ledvice in ga vtisnite v utor |
| <b>Material:</b>          | 90° Shore A NBR   |
| <b>Uporaba</b>            | Hidravlika  |

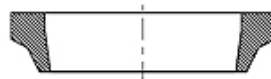

| Toleranz / Tolerance |            |            |            |
|----------------------|------------|------------|------------|
| d                    | D          | L          | C          |
| h11                  | +0,20<br>0 | +0,10<br>0 | +0,20<br>0 |

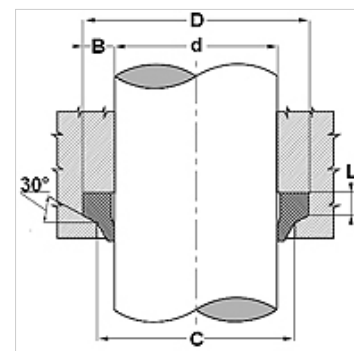

**Opis**

enostavna rešitev.  
enostavna montaža

**Navodila za naročanje**

V primeru posebnih delovnih pogojev (tekočina, temperatura, tlak ...) nas, prosimo, pokličite.  
Drug možni material: FPM.

**Artikel**

| Opis        | d<br>(mm) | D<br>(mm) | L<br>(mm) | C<br>(mm) |
|-------------|-----------|-----------|-----------|-----------|
| WRS 751 25  | 19,05     | 31,75     | 5,3       | 25,45     |
| WRS 100 150 | 25,40     | 38,10     | 5,3       | 31,80     |
| WRS 129 179 | 33,00     | 45,70     | 5,3       | 39,40     |
| WRS 157 207 | 40,00     | 52,70     | 5,3       | 46,40     |
| WRS 187 237 | 47,62     | 60,32     | 5,3       | 54,02     |
| WRS 196 246 | 50,00     | 62,70     | 5,3       | 56,40     |
| WRS 200 250 | 50,80     | 63,50     | 5,3       | 57,20     |
| WRS 220 270 | 56,00     | 68,70     | 5,3       | 62,40     |
| WRS 225 275 | 57,15     | 69,85     | 5,3       | 63,55     |
| WRS 236 286 | 60,00     | 72,70     | 5,3       | 66,40     |
| WRS 248 298 | 63,00     | 75,70     | 5,3       | 69,40     |
| WRS 275 325 | 70,00     | 82,70     | 5,3       | 76,40     |
| WRS 300 350 | 76,20     | 88,90     | 5,3       | 82,40     |
| WRS 315 365 | 80,00     | 92,70     | 5,3       | 86,40     |
| WRS 325 375 | 82,55     | 95,25     | 5,3       | 88,95     |
| WRS 346 396 | 88,00     | 100,70    | 5,3       | 94,40     |
| WRS 374 424 | 95,00     | 107,70    | 5,3       | 101,40    |
| WRS 600 650 | 152,40    | 165,10    | 5,3       | 158,40    |