

# K-DRS ELK GERAETESTECKER

Pressure switches, connection with plug connector, type A acc. to DIN 43650

**HANSA FLEX**

## Lastnosti

<b>Območje uporabe</b>	Pneumatic applications
<b>pogostost preklapljanja</b>	200/min.
<b>napetost preklopa</b>	max. 250 V AC / 28 V DC
<b>razred zaščite</b>	IP 65 (DIN 43650), IP 67 (M 12 x 1)
<b>območje temperatur:</b>	-10 °C to +80 °C
<b>nastavitvena kapa</b>	Aluminium, powder-coated
<b>ohišje</b>	Special die-cast material
<b>membrana, tesnilo</b>	NBR

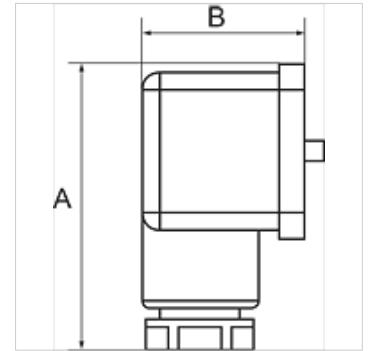

## Navodilo

Drugi podatki na zahtevo.

## Opis

For converting pneumatic to electrical signals. Designed for use in rough vacuum applications (technical vacuum). Universal switch type, suitable as NC, NO or changeover contact. These devices are free from paint-wetting impairment substances (PWIS).

## Artikel

Opis	Priključek	območje nastavitve	A (mm)	B (mm)
K- 07 30 28 45	G 1/4	0,2 - 2,0 bar	48,0	28,0
K- 07 30 28 46	G 1/4	0,5 - 8,0 bar	48,0	28,0
K- 07 30 28 47	G 1/4	1,0 - 16,0 bar	48,0	28,0