

K-DRS ELK ANSCHLUSS M 1

Pressure switches, electrical connection M 12 x 1

Lastnosti

Območje uporabe	Pneumatic applications
pogostost preklapljanja	200/min.
napetost preklopa	max. 250 V AC / 28 V DC
razred zaščite	IP 65 (DIN 43650), IP 67 (M 12 x 1)
območje temperatur:	-10 °C to +80 °C
nastavitvena kapa	Aluminium, powder-coated
ohišje	Special die-cast material
membrana, tesnilo	NBR

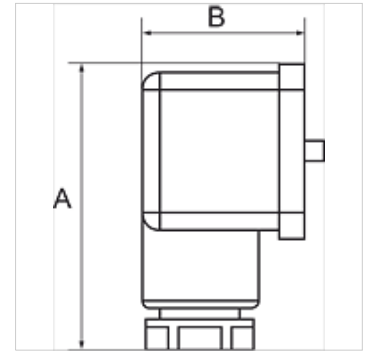

Navodilo

Drugi podatki na zahtevo.

Opis

For converting pneumatic to electrical signals. Designed for use in rough vacuum applications (technical vacuum). Universal switch type, suitable as NC, NO or changeover contact. These devices are free from paint-wetting impairment substances (PWIS).

Artikel

Opis	Priključek	območje nastavitve	A (mm)	B (mm)
K- 07 30 28 48	G 1/4	0,2 - 2,0 bar	48,0	28,0
K- 07 30 28 49	G 1/4	0,5 - 8,0 bar	48,0	28,0
K- 07 30 28 50	G 1/4	1,0 - 16,0 bar	48,0	28,0