

K-DRS ELK GERAETESTECKER VAKUUM

Pressure switches, connection with plug connector, type A acc. to DIN 43650

HANSA FLEX

Lastnosti

Območje uporabe	Pneumatic applications
pogostost preklapljanja	200/min.
napetost preklopa	max. 250 V AC / 28 V DC
območje nastavitve	-0.85 / +1 bar
razred zaščite	IP 65 (DIN 43650), IP 67 (M 12 x 1)
območje temperatur:	-10 °C to +80 °C
nastavitvena kapa	Aluminium, powder-coated
ohišje	Special die-cast material
membrana, tesnilo	Perbunan

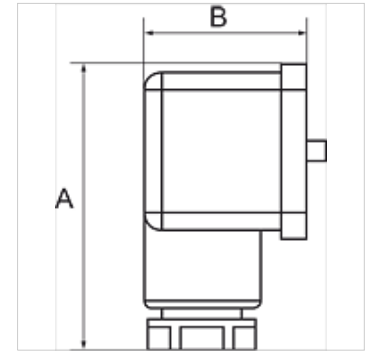

Navodilo

Drugi podatki na zahtevo.

Opis

For converting pneumatic to electrical signals. Designed for use in rough vacuum applications (technical vacuum). Universal switch type, suitable as NC, NO or changeover contact. These devices are free from paint-wetting impairment substances (PWIS).

Artikel

Opis	Priključek	A (mm)	B (mm)
K- 07 30 28 51	Prirobnica	48,0	28,0
K- 07 30 28 53	G 1/4	48,0	28,0